

**LOS ANGELES COUNTY
DEPARTMENT OF PUBLIC WORKS**

BENCH MARK LIST



**BELLFLOWER QUAD
LAKEWOOD QUAD**

1995 ADJUSTMENT

**NAVD 88 DATUM
METRIC**

ABBREVIATIONS USED IN BENCH MARKS (CON'T)

N/O ----- North of
NR ----- Near
OPP ----- Opposite
PI ----- Point of Intersection
PK&W ----- PK Nail and Washer
P/L ----- Property Line
POST ----- Point of Semi-Tangent
PP ----- Power Pole
PVMT ----- Pavement
PROD ----- Produced
RD ----- Road
RDBM ----- Road Dept. Bench Mark
RDBM TAG ----- Road Dept. Bench Mark Tag
RR ----- Railroad
RT ----- Right
R/W ----- Right of Way
SDMH ----- Storm Drain Manhole
SMH ----- Sewer Manhole
SPK ----- Spike
ST&W ----- Spike Tin and Washer
S/O ----- South of
TP ----- Telephone Pole
USC&GS ----- U.S. Coast and Geodetic Survey
USGS ----- U.S. Geological Survey
WK ----- Walk
W/O ----- West of

ABBREVIATIONS USED IN BENCH MARK LISTINGS

ABUT -----	Abutment	ECR -----	End of Curb Return
ALG -----	Along	EC -----	End of Curve
ANG PT -----	Angle Point	ENT -----	Entrance
B/W -----	Back of Walk	FL -----	Floor
BCR -----	Beginning of Curb Return	FTG -----	Footing
BC -----	Beginning of Curve	FRWY -----	Freeway
BLDG -----	Building	F/W -----	Front of Walk
BM -----	Bench Mark	GAR -----	Garage
BT SPK -----	Boat or Bolt Spike	HDWL -----	Headwall
BR CAP -----	Brass or Bronze Cap	HSE -----	House
C B -----	Catch Basin	HWY -----	Highway
CTR -----	Center	INT -----	Intersection
C/L -----	Center Line	IP -----	Iron Pipe
C/L INT -----	Center Line Intersection	LT -----	Left
C/L PROD -----	Center Line Produced	LACE -----	L.A. City Engineer
CONC -----	Concrete	LACS -----	L.A. Co. Engineer
COR -----	Corner	LAFC -----	L.A. Co. Flood Control
CCE -----	Corps of Engineers	L&BN -----	Lead and Bench Nail
CULV -----	Culvert	L&BR -----	Lead and Brad
CYN -----	Canyon	L&N -----	Lead and Nail
CB -----	Curb	L&SPK -----	Lead and Spike
CS MON -----	Co. Eng. Monument	L&T -----	Lead and Tack
CT SPK -----	Cut Spike	MCR -----	Middle of Curb Return
DPW -----	Dept. of Public Works	MKD -----	Marked
DR -----	Drive or Driveway	MC -----	Middle of Curve
E/O -----	East of	MON -----	Monument

QUAD

NORWALK

QUAD

QUAD

ESSIA

10218
10844

9305
9306

7772
7773

9304

11080

9293
10843

11079

10222

9290

9289

10223

9288

769

7029

9287

9286

9285

2596

766

765

763

2597

7028

7078

9375

9376

2616

9377

GARFIELD AVE

CHERRY AVE

ARTESIA

8781
8782

W E R

QUAD

EL AMO BLVD

RD

ACH

10328
10327

11078

9288

10224

9285

766

765

763

2597

7028

11116

11115

11114

11113

11112

11111

11110

960

9375

9376

2616

9377

9378

9379

8808

9381

9382

7080

11076

9383

10238

11075

8810

8811

804

803

9288

10224

9285

766

765

763

2597

7028

11116

11115

11114

11113

11112

11111

11110

960

9375

9376

2616

9377

9378

9379

8808

9381

9382

7080

11076

9383

10238

11075

8810

8811

804

803

9288

10224

9285

766

765

763

2597

7028

11116

11115

11114

11113

11112

11111

11110

960

9375

9376

2616

9377

9378

9379

8808

9381

9382

7080

11076

9383

10238

11075

8810

8811

804

803

9288

10224

9285

766

765

763

2597

7028

11116

11115

11114

11113

11112

11111

11110

960

9375

9376

2616

9377

9378

9379

8808

9381

9382

7080

11076

9383

10238

11075

8810

8811

804

803

9288

10224

9285

766

765

763

2597

7028

11116

11115

11114

11113

11112

11111

11110

960

9375

9376

2616

9377

9378

9379

8808

9381

9382

7080

11076

9383

10238

11075

8810

8811

804

803

9288

10224

9285

766

765

763

2597

7028

11116

11115

11114

11113

11112

11111

11110

960

9375

9376

2616

9377

9378

9379

8808

9381

9382

7080

11076

9383

10238

11075

8810

8811

804

803

9288

10224

9285

766

765

763

2597

7028

11116

11115

11114

11113

11112

11111

11110

960

9375

9376

2616

9377

9378

9379

8808

9381

9382

7080

11076

9383

10238

11075

8810

8811

804

803

9288

10224

9285

766

765

763

2597

7028

11116

11115

11114

11113

11112

11111

11110

960

9375

9376

2616

9377

9378

9379

8808

9381

9382

7080

11076

9383

10238

11075

8810

8811

804

803

9288

10224

9285

766

765

763

2597

SOUTH GATE QUAD

NOR

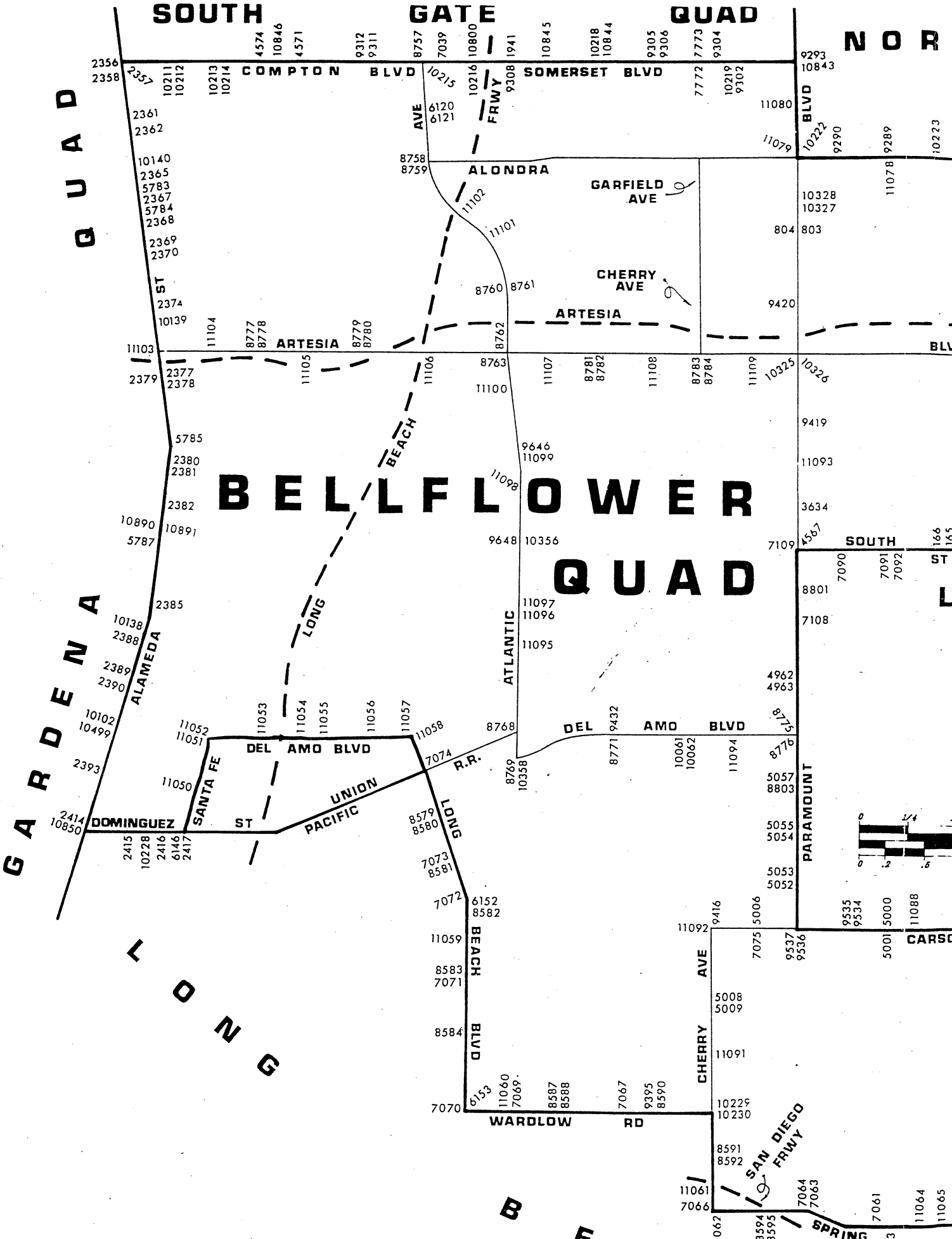

BELFLOWER QUAD

LIGHT SOLID LINES WITHOUT NUMBERS INDICATE PREVIOUS LINES OF BENCH MARKS THAT ARE NOT INCLUDED IN THE 1980 ADJUSTMENT.

Q U A D

B E L L F L O W E R

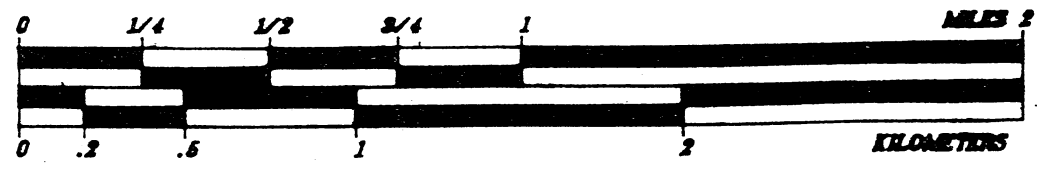
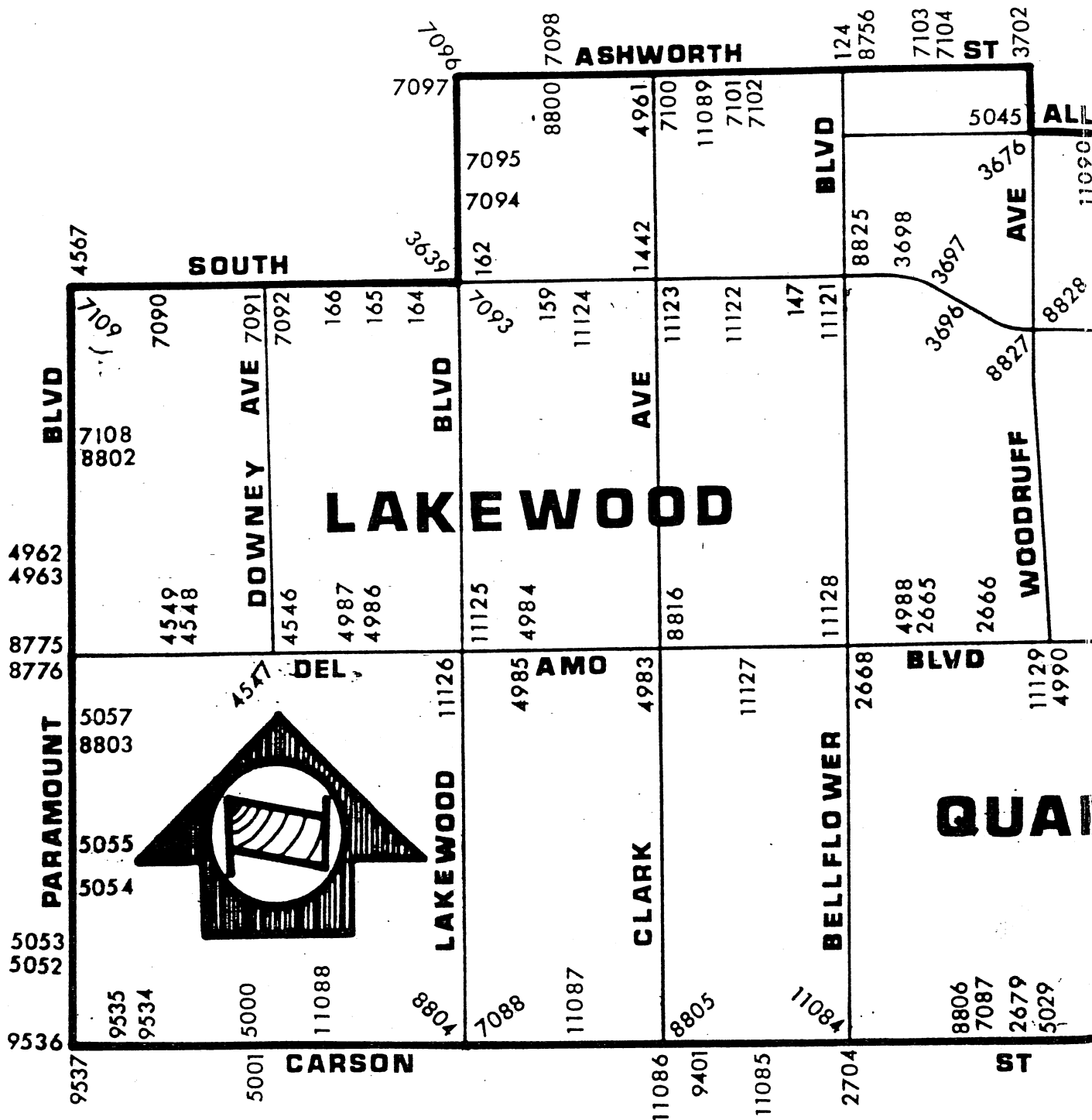

LIGHT SOLID LINES WITHOUT NUMBERS INDICATE PREVIOUS LINES OF BENCH MARKS THAT ARE NOT INCLUDED IN THE 1980 ADJUSTMENT.

JAD-YEAR	ELEV METER/FOOT	D E S C R I P T I O N (INCLUDE QUAD AND YEAR IN DESCRIPTION)	BM NUMBER
BELLFLOWER (1995)	0019.036 0062.454	L&SPK IN W CB 1.5M N/O BCR @ NW COR BELLFLOWER BLVD & ROSE ST 12.8M W & 12.2M N/O C/L INT	Y 123
BASELINE (1995)	0018.695 0061.335	L&T IN N CB 300MM W/O BCR @ NW COR ASHWORTH ST & BELLFLOWER BLVD 19M W & 5.5M N/O C/L INT	Y 124
LAKWOOD (1995)	0017.403 0057.096	BT SPK IN E CB 3.4M N/O BCR @ NE COR SOUTH ST & AUTRY AVE 26M N & 5M E/O C/L INT	Y 147
LAKWOOD (1995)	0017.255 0056.611	L&T IN N CB (SERV RD) 2.4M W BCR @ NW COR SOUTH ST & GRAYWOOD AVE 24.4M N & 14.6M W/O C/L INT	Y 159
LAKWOOD (1995)	0017.157 0056.289	L&T IN N CB (SERV RD) 1.5M W BCR @ NW COR SOUTH ST & BONFAIR AVE 24.4 N & 15.2M W/O C/L INT	Y 162
BASELINE (1995)	0016.945 0055.594	L&T IN W CB 300MM N/O BCR @ NW COR SOUTH ST & OLIVIA AVE 34M N & 6.1M W/O C/L INT	Y 164
BASELINE (1995)	0016.816 0055.170	L&T IN N CB (SERV RD) 600MM W/O BCR @ NW COR CASTANA AVE & SOUTH ST 27M N & 17.4M W/O C/L INT	Y 165
LAKWOOD (1995)	0016.723 0054.865	L&T IN N CB (SERV RD) 300MM W/O BCR @ NW COR HAYTER AVE & SOUTH ST 27M N & 17M W C/L INT	Y 166
BASELINE (1995)	0022.958 0075.321	CS MON IN WELL IN RET OF WALK 5.5M NW/O BCR @ NE COR ALONDRA BLVD & WOODRUFF AVE 17M N & 18M E/O C/L INT MKD (BM #4 CLEARWATER K 2A 1961)	Y 473A
BASELINE (1995)	0023.582 0077.369	L&T IN W CB 4.3M N/O BCR @ NW COR ALONDRA BLVD & LEAHY AVE 24.4M N & 4.6M W/O C/L INT	Y 479
BASELINE (1995)	0022.560 0074.016	L&T IN N CB 600MM W/O BCR @ NW COR ALONDRA BLVD & RYON AVE 11.6M N & 9.8M W/O C/L INT	Y 763
BASELINE (1995)	0023.104 0075.800	L&BN IN S CB 150MM E/O BCR @ SE COR ALONDRA BLVD & PACIFIC AVE 21.3M W/O PERR	Y 765A
BASELINE (1995)	0021.593 0070.843	L&SPK IN N CB 1.2M E/O BCR @ NE COR CLARK AVE & ALONDRA BLVD 18M E & 11.6M N/O C/L INT	Y 766
BASELINE (1995)	0021.529 0070.633	L&T @ C/L INT PITTS AVE & ALONDRA BLVD	Y 769
BELLFLOWER (1995)	0020.679 0067.844	L&T IN E CB 1.5M N/O BCR @ NE COR PARAMOUNT BLVD & 70TH ST 17.4M N & 10M E/O C/L INT	Y 803A
BELLFLOWER (1995)	0020.584 0067.533	CLB MON IN WELL 150MM DN @ OR NR C/L INT 70TH ST & PARAMOUNT BLVD MKD (1961)	Y 804A

JAD-YEAR	ELEV METER/FOOT	D E S C R I P T I O N (INCLUDE QUAD AND YEAR IN DESCRIPTION)	BM NUMBER
BASELINE (1995)	0023.084 0075.735	L&T IN CB RET 300MM E/O BCR @ SW COR ALONDRA BLVD & WOODRUFF AVE 21M W & 11.6M S/O C/L INT	Y 960
LAKESWOOD (1995)	0017.090 0056.069	L&T IN N CB 2.1M W/O BCR @ NW COR SOUTH ST & CLARK AVE 18.3M W & 15.8M N/O C/L INT	Y 1442
BASELINE (1995)	0027.515 0090.272	RD BM TAG IN E ABUT @ NE COR BRIDGE OVER L A RIVER 300MM N/O CF & 7.3M N/O C/L SOMERSET BLVD	Y 1941A
BASELINE (1995)	0021.551 0070.705	L&BN 8.5M N/O C/L COMPTON BL & 18.3M W/O C/L ALAMEDA ST (E BBL) 4M E/O E RAIL SPRR	Y 2356
BASELINE (1995)	0021.616 0070.918	L&BN IN S CB 8.5M W/O BCR @ SW COR ALAMEDA ST (E BBL) & COMPTON BL 21.3M W & 8.5M S/O C/L INT (1.5M E/O E RAIL SPRR)	Y 2357
BASELINE (1995)	0020.581 0067.523	L&T IN W CB 7.6M W/O C/L ALAMEDA ST (E BBL) ON C/L PROD LAUREL ST (FR THE EAST)	Y 2358
BASELINE (1995)	0020.491 0067.228	CS MON IN WELL 250MM DN 8.2M W/O C/L ALAMEDA ST (E BBL) & 5.5M S/O C/L PROD MYRRH ST (TO THE E) 15.2M E/O C/L SPRR MKD (BM 5-22A)	Y 2361A
BASELINE (1995)	0020.320 0066.668	L&BN IN W CB ALAMEDA ST (E BBL) 7.6M W/O C/L & 13.4M S/O C/L NLY MOST DRWY TO BLDG #550-A	Y 2362
BASELINE (1995)	0019.732 0064.737	L&T IN E CB ALAMEDA ST (W BBL) 8.2M E/O C/L ON C/L PROD RAYMOND AVE	Y 2365
BASELINE (1995)	0019.546 0064.127	L&T IN E CB ALAMEDA ST (W BBL) 8.2M E/O C/L ON C/L PROD TICHNOR ST	Y 2367
BASELINE (1995)	0019.477 0063.900	L&T IN E CB ALAMEDA ST (W BBL) 7.9M E/O C/L ON C/L PROD CALDELL ST	Y 2368
BASELINE (1995)	0019.391 0063.617	L&T IN E CB ALAMEDA ST (W BBL) 8.2M E/O C/L ON C/L PROD JOHNSON ST	Y 2369
BASELINE (1995)	0019.294 0063.300	L&T IN E CB ALAMEDA ST (W BBL) 8.2M E/O C/L ON C/L PROD BENNET ST	Y 2370
BASELINE (1995)	0018.896 0061.995	USC&GS DISC IN CONC POST 900MM N/O PP MKD #495 11.6M E/O C/L SPRR 34.4M E/O C/L ALAMEDA ST (W BBL) 241M S/O GREENLEAF BLVD MKD (Q 768 1945)	Y 2374
BASELINE (1995)	0019.853 0065.136	L&BN IN E CB ALAMEDA ST @ ANGLE PT OF WINGWALL @ NE COR BRIDGE #774 OVER COMPTON CREEK 6.7M E/O C/L & 53M N/O C/L CHANNEL & 122M S/O C/L ARTESIA BLVD	Y 2377

JAD-YEAR	ELEV METER/FOOT	DESCRIPTION (INCLUDE QUAD AND YEAR IN DESCRIPTION)	BM NUMBER
BASELINE (1995)	0018.409 0060.397	FC BR CAP IN S END OF WINGWALL @ NE COR SPRR BRIDGE 27.4M E/O C/L ALAMEDA ST & 137M S/O C/L ARTESIA BLVD MKD (RBM 44-33)	Y 2378
BASELINE (1995)	0019.864 0065.170	FC BR DISC 1.5M S ANGLE PT OF WINGWALL @ SW COR BRIDGE #774 ON ALAMEDA ST OVER COMPTON CREEK 8.5 M W/O C/L & 183M S/O ARTESIA BL MKD (BM 44-33)	Y 2379
BASELINE (1995)	0016.341 0053.612	FC BR DISC IN E CB 212M S & 6.7M E/O C/L INT ALAMEDA ST & HOMESTEAD PL 93M N/O C/L INT TO DOMINGUEZ SEMINARY #18127 MKD (RBM 44-32)	Y 2380
BASELINE (1995)	0016.786 0055.072	FC BR DISC IN SE COR 2.4X2.4M CONC VALVE BOX 21.3M S & 38M E/O C/L INT ALAMEDA ST & HOMESTEAD PL 90M N/O C/L ENT TO DOMINQUEZ SEMINARY #18127 MKD (BM 44-32)	Y 2381
BASELINE (1995)	0016.084 0052.769	L&BN IN W CB ALAMEDA ST 6.7M W/O C/L & 7.3M N/O C/L NLY MOST DRWY TO SO CALIF EDISON SUB-STA 520M S/O HOMESTEAD PL	Y 2382
BASELINE (1995)	0014.680 0048.163	L&BN IN E CB ALAMEDA ST (W BBL) 6.7M E/O C/L 402M N/O LAUREL PARK RD 77.4M S/O C/L PROD SANTA FE AVE	Y 2385
BASELINE (1995)	0013.789 0045.240	USGS DISC IN CONC POST 9.1M E C/L SPRR & 16.8M W/O C/L ALAMEDA ST (E BBL) 1.2M N/O PP (LU) OPP BLDG #19600 DEL AMO BLVD MKD (P 768 1945)	Y 2388
BASELINE (1995)	0013.317 0043.691	L&BN IN E CB ALAMEDA ST (W BBL) 6.7M E/O C/L & 161M N/O VISTA INDUSTRIA OPP BLDG #19722	Y 2389
BASELINE (1995)	0013.179 0043.238	CUT SPK IN E CB ALAMEDA ST (W BBL) 6.7M E & 35M S/O C/L VISTA INDUSTRIA (402M N/O DEL AMO BLVD)	Y 2390
BASELINE (1995)	0010.676 0035.026	L&SPK IN E CB ALAMEDA ST (W BBL) 6.7M E/O C/L & 84M N/O C/L EL PRESIDIO ST (402M S DEL AMO BL)	Y 2393
BASELINE (1995)	0010.374 0034.035	L&T IN NR MCR @ SE COR ALAMEDA ST (E BBL) & DOMINGUEZ ST 13.7M E & 6.7M S/O C/L INT	Y 2414
BASELINE (1995)	0010.279 0033.724	L&T IN S CB DOMINGUEZ ST 8M S/O C/L & 2.7M W/O C/L DRWY TO HSE #2638 (241M E/O ALAMEDA ST)	Y 2415
BASELINE (1995)	0010.462 0034.324	L&T IN S CB DOMINGUEZ ST 8M S/O C/L & 9.4M W/O C/L DRWY TO HSE #2738 (@ F HYD)	Y 2416
BASELINE (1995)	0010.701 0035.108	L&SPK IN W CB 900MM S BCR @ SW COR DOMINGUEZ ST & SANTA FE AVE 11.6M S & 12.2M W/O C/L INT	Y 2417

JAD-YEAR	ELEV METER/FOOT	DESCRIPTION (INCLUDE QUAD AND YEAR IN DESCRIPTION)	BM NUMBER
BASELINE (1995)	0021.225 0069.636	CS MON IN WELL IN ST 2.1M S/O N CF 6.4M E/O BCR @ NE COR ALONDRA BLVD & CLARK AVE 21.5M E & 9.1M N/O C/L INT MKD (BM 6-8 1951 RE 5869)	Y 2596
BASELINE (1995)	0023.018 0075.518	L&BR IN N CB 1.2M W/O BCR @ NW COR ALONDRA BLVD & BLAINE AVE 11.6M N & 10.7M W/O C/L INT	Y 2597
BASELINE (1995)	0023.263 0076.322	L&BN IN S CB 300MM W/O BCR @ SW COR ALONDRA BL & BELLFLOWER BL 14M W & 11.6M S/O C/L INT	Y 2600
BASELINE (1995)	0022.927 0075.220	L&T IN N CB 300MM E/O BCR @ NE COR ALONDRA BLVD (SERV RD) & DUMONT AVE	Y 2616
BASELINE (1995)	0023.098 0075.781	L&T IN N CB 300MM E/O BCR @ NE COR ALONDRA BLVD (SERV RD) & LEIBACHER AV 25M N & 14.6M E C/L INT	Y 2617
LAKESWOOD (1995)	0015.599 0051.178	RDBM TAG IN N CB 300MM E/O BCR @ NE COR DEL AMO BLVD & DUNROBIN AVE 24.4M N & 13M E/O C/L INT	Y 2665A
LAKESWOOD (1995)	0015.210 0049.901	L&BN IN CTR CB RET @ SW COR LOMINA AVE & DEL AMO BLVD (SERV RD) 7M S & 7M W/O C/L INT	Y 2666
LAKESWOOD (1995)	0015.616 0051.233	L&T IN E CB 1.5M N/O BCR @ SE COR BELLFLOWER BLVD & DEL AMO BLVD 20M S & 11.6M E/O C/L INT	Y 2668A
BASELINE (1995)	0014.376 0047.165	L&T IN N CB 600MM W/O BCR @ NW COR WOODRUFF AVE & CARSON ST 24M W & 12.8M N/O C/L INT	Y 2679
BASELINE (1995)	0012.852 0042.165	RDBM TAG IN S CB 300MM W/O BCR @ SW COR CARSON ST & BELLFLOWER BLVD 21M W & 11.6M S/O C/L INT	Y 2704A
BASELINE (1995)	0007.586 0024.888	L&N IN S CB SPRING ST (N SERV RD) 4.3M S/O C/L (SERV RD) ON C/L PROD LOMINA AVE	Y 2941
BASELINE (1995)	0007.345 0024.098	L&T IN CTR OF ISL S END PARKWAY SAN ANSEL AVE 8.5M N/O C/L SPRING ST (SERV RD)	Y 2942
BASELINE (1995)	0007.624 0025.013	L&T IN S CB SPRING ST (SERV RD) 4.3M S/O C/L ON C/L PROD CHATWIN AVE	Y 2943
BASELINE (1995)	0007.503 0024.616	L&BN IN N CB 300MM E/O BCR @ NE COR SPRING ST & BELLFLOWER BLVD 25M E & 16.5M N/O C/L INT	Y 2944
BASELINE (1995)	0007.226 0023.707	CS MON IN WELL 350MM DN @ C/L INT SPRING ST & BELLFLOWER BLVD MKD (CTR SEC 22 R12W T4S)	Y 2946
BELLFLOWER (1995)	0016.621 0054.531	L&BN 3M W/O W CF IN CONC BASE OF S GATE POST 25.3M N/O C/L NLY MOST DRWY TO 5905 PARAMOUNT BLVD (ARCO TERMINAL) 15.2M W/O C/L	Y 3634

JAD-YEAR	ELEV METER/FOOT	D E S C R I P T I O N (INCLUDE QUAD AND YEAR IN DESCRIPTION)	BM NUMBER
BASELINE (1995)	0017.123 0056.178	L&BN IN N CB 300MM W/O BCR @ NW COR LAKEWOOD BLVD & SOUTH ST 24.4M W & 15.5M N/O C/L INT	Y 3639
BASELINE (1995)	0017.926 0058.812	L&BN IN S CB 300MM W/O BCR @ SW COR ALLINGTON ST & WOODRUFF AVE 23M W & 8.5M S/O C/L INT	Y 3676
BASELINE (1995)	0018.003 0059.065	L&BR IN W CB 900MM N/O BCR @ NW COR ALLINGTON ST & CANEHILL AVE 23M N & 5.5M W/O C/L INT	Y 3679A
BASELINE (1995)	0018.168 0059.606	RDBM TAG IN S CB 300MM E BCR @ SE COR ALLINGTON ST & CANEHILL AVE 18.3M E & 9.1M S/O C/L INT	Y 3680A
BASELINE (1995)	0017.706 0058.090	CS MON @ C/L INT PALO VERDE AVE & ALLINGTON ST	Y 3681
LAKWOOD (1995)	0016.357 0053.665	L&BN IN W CB 4.6M N/O BCR @ NW COR SOUTH ST & SNOWDEN AVE 36.6M N & 5.5M W/O C/L INT	Y 3690A
LAKWOOD (1995)	0017.183 0056.375	L&BN IN S CB 300MM W/O BCR @ SW COR SOUTH ST & OCANA AVE 24.4M S & 14.6M W/O C/L INT	Y 3696
LAKWOOD (1995)	0017.527 0057.503	L&BN IN S CB 300MM W/O BCR @ SW COR SOUTH ST & COLDBROOK AVE 24.4M S & 12.2M W/O C/L INT	Y 3697
LAKWOOD (1995)	0017.484 0057.362	L&BN IN S CB SOUTH ST 12.8M S/O C/L & 4.6M E/O C/L PROD ADENMOOR AVE	Y 3698
LAKWOOD (1995)	0018.378 0060.295	L&T IN W CB 300MM S/O BCR @ SW COR ASHWORTH ST & WOODRUFF AVE 13.7M S & 12.2M W/O C/L INT	Y 3702
LAKWOOD (1995)	0014.926 0048.970	L&T IN E CB 300MM N/O BCR @ NE COR DEL AMO BLVD & DOWNEY AVE 15M N & 9.1M E/O C/L INT	Y 4546
LAKWOOD (1995)	0014.668 0048.123	CS MON IN WELL 300MM DN @ NOSE OF (SERV RD ISL) 13.7M S & 9.8M W/O C/L INT DEL AMO BL & DOWNEY AVE MKD (BM 33-4 1953 RE 63)	Y 4547
LAKWOOD (1995)	0014.988 0049.173	RDBM TAG IN S CB @ SE COR DEL AMO BLVD & OBISPO AVE 35M E & 12.2M S/O C/L INT (23M E/O C/L C B)	Y 4548
LAKWOOD (1995)	0014.982 0049.153	RDBM TAG IN S CB @ SE COR DEL AMO BLVD & OBISPO AVE 26M W & 12.2M S/O C/L INT (13.4M W C/L C B)	Y 4549
BASELINE (1995)	0016.210 0053.182	RDBM TAG IN N CB 600MM E/O BCR @ NE COR SOUTH ST & PARAMOUNT BLVD 23M E & 12.2M N/O C/L INT	Y 4567
BASELINE (1995)	0021.232 0069.659	L&SPK IN S CB 900MM E/O BCR @ SE COR COMPTON BL & BRADFIELD AVE 12.2M S & 12.8M E/O C/L INT	Y 4571

JAD-YEAR	ELEV METER/FOOT	DESCRIPTION (INCLUDE QUAD AND YEAR IN DESCRIPTION)	BM NUMBER
BASELINE (1995)	0020.852 0068.412	CITY OF COMPTON MON IN WELL 300MM DN @ C/L INT COMPTON BL & LONG BEACH BL (1.5M N/O MON TO S)	Y 4574
BASELINE (1995)	0018.242 0059.849	CS MON IN WELL IN CB RET 1.8M N/O BCR @ SW COR CLARK AVE & ASHWORTH ST 11.6M S & 9.1M W/O C/L INT MKD (BM 32- 3)	Y 4961
BASELINE (1995)	0014.930 0048.983	RDBM TAG IN W CB 1.8M N/O BCR @ NW COR HARDWICK ST & PARAMOUNT BLVD 13.7M N & 12.2M W/O C/L INT	Y 4962
BASELINE (1995)	0014.961 0049.085	RDBM TAG IN W CB 600MM S BCR @ SW COR HARDWICK ST & PARAMOUNT BLVD 11.3M S & 13M W/O C/L INT	Y 4963
LAKWOOD (1995)	0015.018 0049.272	L&BR IN CHIS SQ 900MM W/O BCR @ NW COR DEL AMO BLVD & CLARK AVE 15.2M W & 12.2M N/O C/L INT	Y 4983
LAKWOOD (1995)	0015.279 0050.128	RDBM TAG IN N CB 300MM E/O BCR @ NE COR DEL AMO BLVD & GRAYWOOD AVE 20M E & 15.2M N/O C/L INT	Y 4984
LAKWOOD (1995)	0015.235 0049.983	RDBM TAG IN N CB 1.5M W/O BCR @ NW COR DEL AMO BLVD & GRAYWOOD AVE 21.3M W & 12.2M N/O C/L INT	Y 4985
LAKWOOD (1995)	0014.697 0048.218	RDBM TAG N CB (SERV RD) 1.5M E BCR @ NE COR DEL AMO BL & COKE AVE 24.4M N & 14.6M E/O C/L INT	Y 4986
LAKWOOD (1995)	0014.785 0048.507	RDBM TAG N CB (SERV RD) 1.2M W BCR @ NW COR DEL AMO BL & COKE AVE 24.4M N & 12.8M W/O C/L INT	Y 4987
LAKWOOD (1995)	0015.650 0051.345	RDBM TAG IN N CB 600MM W/O BCR @ NW COR DEL AMO BL & DUNROBIN AVE 24.4M N & 14.6M W/O C/L INT	Y 4988
LAKWOOD (1995)	0014.808 0048.583	L&T IN E CB 2.7M S/O BCR @ SE COR DEL AMO BLVD & WOODRUFF AVE 26M S & 12.2M E/O C/L INT	Y 4990
LAKWOOD (1995)	0013.873 0045.515	RDBM TAG IN S CB 300MM W/O BCR @ SW COR DEL AMO BLVD & MCNAB AVE 24.4M S & 13M W/O C/L INT	Y 4991
LAKWOOD (1995)	0013.924 0045.682	RDBM TAG IN S CB 300MM E/O BCR @ SE COR DEL AMO BLVD & MCNAB AVE 24.4M S & 13M E/O C/L INT	Y 4992
BASELINE (1995)	0013.912 0045.643	CS MON IN WELL 250MM DN @ SW COR PALO VERDE AVE & DEL AMO BL 26M S & 7M W/O C/L INT MKD BM 9-10	Y 4993
BASELINE (1995)	0014.258 0046.778	L&T IN E CB 4.9M S/O BCR @ SE COR PALO VERDE AVE & DEL AMO BLVD 27M S & 9.1M E/O C/L INT	Y 4994
BASELINE (1995)	0017.503 0057.424	USC&GS BR DISC 11M W/O E END HDWL CONC BRIDGE 2.4M N/O CF 15.2M N/O C/L CARSON ST & 248M E/O C/L CLUBHOUSE DR MKD (C780 1946)	Y 5000

JAD-YEAR	ELEV METER/FOOT	D E S C R I P T I O N (INCLUDE QUAD AND YEAR IN DESCRIPTION)	BM NUMBER
BASELINE (1995)	0017.513 0057.457	SQ HD BT IN E END HDWL CONC BRIDGE 2.4M S/O CF 15.2M S/O C/L CARSON ST & 248M E/O C/L WATSON PLAZA DR MKD (U)	Y 5001
BELLFLOWER (1995)	0021.184 0069.501	L&BR IN W CB 300MM N/O BCR @ NW COR CARSON ST & DEEBOYER AVE 27M N & 5.5M W/O C/L INT	Y 5006
BELLFLOWER (1995)	0019.673 0064.544	RDBM TAG IN N CB 300MM E/O BCR @ NE COR CHERRY AVE & BIXBY AVE 27M E & 9.1M N/O C/L INT	Y 5008
BELLFLOWER (1995)	0019.653 0064.478	RDBM TAG IN S CB 900MM E/O BCR @ SE COR CHERRY AVE & BIXBY AVE 28M E & 9.1M S/O C/L INT	Y 5009
BASELINE (1995)	0015.212 0049.908	L&T IN S CB 900MM W/O BCR @ SW COR PALO VERDE AVE & CANDLEWOOD ST 20.7M W & 11.6M S/O C/L INT	Y 5017
BASELINE (1995)	0014.862 0048.760	L&BR IN E CB 300MM N/O BCR @ NE COR EBERLE ST & PALO VERDE AVE 15.2M N & 9.1M E/O C/L INT	Y 5019
BASELINE (1995)	0012.474 0040.925	CS MON IN WELL 250MM DN @ OR NR C/L INT ARBOR RD & PALO VERDE AVE	Y 5020
BASELINE (1995)	0013.268 0043.530	L&BN IN N CB 22M W/O BCR @ NW COR PALO VERDE AVE & ARBOR RD 42M W & 5.5M N/O C/L INT	Y 5021
BASELINE (1995)	0011.705 0038.402	CS MON IN WELL 300MM DN @ OR NR C/L INT PALO VERDE AVE & CENTRALIA ST	Y 5022
BASELINE (1995)	0011.398 0037.395	CS MON IN WELL 300MM DN @ OR NR C/L INT HARVEY WAY & PALO VERDE AVE	Y 5024
BASELINE (1995)	0011.734 0038.497	L&BN IN E CB 300MM S/O BCR @ SE COR PALO VERDE AVE & HARVEY WAY 17.4M S & 9.1M E/O C/L INT	Y 5025
BASELINE (1995)	0011.823 0038.789	RDBM TAG IN W CB 1.8M N/O BCR @ NW COR CARSON ST & PALO VERDE AVE 25M N & 9.1M W/O C/L INT	Y 5026
BASELINE (1995)	0011.809 0038.743	RDBM TAG IN E CB 1.8M N/O BCR @ NE COR CARSON ST & PALO VERDE AVE 25M N & 9.1M E/O C/L INT	Y 5027
BASELINE (1995)	0014.307 0046.939	CS MON IN WALK NR CTR CB RET @ NW COR CARSON ST & WOODRUFF AVE 17.4M N & 14.6M W/O C/L INT MKD (CLEARWATER K 9 RM #3 1954 RE 63)	Y 5029
BASELINE (1995)	0013.532 0044.396	RDBM TAG IN S CB OF (SERV RD) CARSON ST 16.5M N/O C/L (@ HSE #6133)	Y 5030
BASELINE (1995)	0013.389 0043.927	RDBM TAG IN N CB OF (SER RD) CARSON ST 25M N/O C/L (@ HSE #6133)	Y 5031

JAD-YEAR	ELEV METER/FOOT	DESCRIPTION (INCLUDE QUAD AND YEAR IN DESCRIPTION)	BM NUMBER
BASELINE (1995)	0017.782 0058.340	L&T IN E CB 300MM S/O BCR @ SE COR WOODRUFF AVE & ALLINGTON ST 23M S & 12.2M E/O C/L INT	Y 5045
BASELINE (1995)	0019.776 0064.882	RDBM TAG IN W CB (SERV RD) 600MM S BCR @ SW COR PARAMOUNT BLVD & WARWOOD RD 14.3M S & 23.2M W/O C/L INT	Y 5052
BASELINE (1995)	0019.765 0064.846	RDBM TAG IN W CB (SERV RD) 600MM N/O BCR @ NW COR PARAMOUNT BLVD & WARWOOD RD 14.6M N & 23.2M W/O C/L INT	Y 5053
BASELINE (1995)	0019.170 0062.894	RDBM TAG IN W CB (SERV RD) 600MM S/O BCR @ SW COR PARAMOUNT BLVD & GREENTOP ST 14M S & 23.2M W/O C/L INT	Y 5054
BASELINE (1995)	0019.086 0062.618	RDBM TAG IN W CB (SERV RD) 600MM N/O BCR @ NW COR PARAMOUNT BLVD & GREENTOP ST 14M N & 23.2M W/O C/L INT	Y 5055
BASELINE (1995)	0017.306 0056.778	RDBM TAG IN W CB (SERV RD) 600MM N/O BCR @ NW COR PARAMOUNT BL & CENTRALIA ST 14.3M N & 23.2M W/O C/L INT	Y 5057
BASELINE (1995)	0020.155 0066.125	RD MON IN N END OF CONC HDWL CULV 13.7M W/O C/L ALAMEDA ST (E BBL) & 5.2M S/O C/L PROD RAYMOND ST 8.2M E/O C/L MAIN TRACK SPRR MKD (BM 19)	Y 5783
BASELINE (1995)	0020.109 0065.974	USC&GS MON IN S END CULV HDWL 3M W/O C/L SPRR & 21.3M E/O C/L ALAMEDA ST (W BBL) 27.4M N/O C/L PROD CALDWELL ST MKD (T 615 1941)	Y 5784
BASELINE (1995)	0017.409 0057.116	MWD MON 900MM E/O E CB ALAMEDA ST 7.9M E/O C/L & 34.4M S/O C/L PROD HOMESTEAD PL MKD (56Z 1933)	Y 5785
BASELINE (1995)	0015.706 0051.529	USC&GS MON IN N END SFRR CULV HDWL 2.4M W C/L TRACKS 20.4M E/O C/L ALAMEDA ST & 106M N/O C/L AC DRWY W ENT TO FIRE STA MKD (F 52 1926) 644M N/O LAURELPARK RD	Y 5787
BELLFLOWER (1995)	0020.402 0066.936	L&T IN E CB 600MM S/O BCR @ SE COR ATLANTIC AVE & MYRRH ST 11M E & 8.2M S/O C/L INT	Y 6120
BELLFLOWER (1995)	0020.400 0066.929	L&T IN W CB 300MM S/O BCR @ SW COR ATLANTIC AVE & MYRRH ST 11M W & 8M S/O C/L INT	Y 6121
BASELINE (1995)	0010.323 0033.868	CS MON IN WELL 21M W & 6M S/O C/L INT SANTA FE AVE & DOMINGUEZ ST MKD (BM 8-57 1951 RE 63)	Y 6146
BASELINE (1995)	0031.950 0104.823	CS TRAV MON IN WELL @ C/L INT LONG BEACH BLVD & SAN ANTONIO DR MKD (CLEARWATER B-8A 1940 RE2177)	Y 6152

JAD-YEAR	ELEV METER/FOOT	D E S C R I P T I O N (INCLUDE QUAD AND YEAR IN DESCRIPTION)	BM NUMBER
BASELINE (1995)	0027.567 0090.443	CS TRAV MON IN WELL ON C/L LONG BEACH BLVD & 2.7M S/O C/L WARDLOW RD MKD (B-10 1940 RE 2177)	Y 6153
BASELINE (1995)	0007.289 0023.914	L&BR IN CHIS SQ W CB 1.8M S BCR @ SW COR SPRING ST & SNOWDEN AVE 30.5M S & 5.5M W/O C/L INT	Y 6158
BASELINE (1995)	0007.728 0025.354	RDBM TAG IN S CB 300MM E/O BCR @ SE COR SPRING ST & SNOWDEN AVE 13.7M S & 14.6M E/O C/L INT	Y 6159
BASELINE (1995)	0022.847 0074.957	CS MON IN WELL IN ST 1.5M S/O N CF 5.5M W/O BCR @ NW COR ALONDRA BLVD & BELLFLOWER BLVD 22M W & 10M N/O C/L INT MKD (BM 6-7 1951 RE 63)	Y 7028
BASELINE (1995)	0021.728 0071.286	CS MON IN S CB @ SE COR ALONDRA BLVD & LAKEWOOD BLVD 57M E & 12.8M S/O E/O C/L INT MKD (BM 6-9A 1958 RE 5869)	Y 7029
BASELINE (1995)	0020.783 0068.186	CS MON IN WELL 300MM DN @ C/L INT SAN LUIS ST & LIME AVE MKD (CO SUR MON RE 329)	Y 7039
BASELINE (1995)	0010.016 0032.861	L&BN IN E CB 300MM S/O BCR @ SE COR CONANT ST & PALO VERDE AVE 16.8M S & 9.1M E/O C/L INT	Y 7056
BASELINE (1995)	0010.008 0032.835	L&T IN N CB 300MM E/O BCR @ NE COR PALO VERDE AVE & CONANT ST 20M E & 6.1M N/O C/L INT	Y 7057
BASELINE (1995)	0011.443 0037.543	CLB MON IN N CB 900MM W/O BCR @ NW COR SPRING ST & REDONDO AVE 12.2M N & 13.7M W/O C/L INT MKD (RE 3111 BM 8-40B C L B 1963)	Y 7061
BASELINE (1995)	0015.007 0049.235	CLB MON IN WELL 600MM N/O N CF @ NE COR SPRING ST & TEMPLE AVE 12.2M N & 10.7M E/O C/L INT MKD (BM 541 1963 RE 3111)	Y 7063
BASELINE (1995)	0015.347 0050.351	L&SM SPK IN E END C B 11.3M W/O BCR @ NW COR SPRING ST & TEMPLE AVE 24.4M W & 12.2M N C/L INT	Y 7064
BASELINE (1995)	0023.729 0077.851	L&BN IN E CB 300MM S/O BCR @ NE COR SPRING ST & CHERRY AVE 25.3M N & 15.2M E/O C/L INT	Y 7066
BASELINE (1995)	0021.917 0071.906	CLB MON IN WELL IN WALK @ NE COR WARDLOW RD & ORANGE AVE 15.5M N & 10M E/O C/L INT MKD (BM 87)	Y 7067
BASELINE (1995)	0027.285 0089.518	CLB MON IN WELL @ C/L INT WARDLOW RD & ATLANTIC AVE (S MON OF 2 MON) MKD (1115 A)	Y 7069
BASELINE (1995)	0027.600 0090.551	RAMSET IN W CB 10.7M N/O BCR @ NW COR WARDLOW RD & LONG BEACH BLVD 37M N & 10.7M W/O C/L INT	Y 7070

JAD-YEAR	ELEV METER/FOOT	D E S C R I P T I O N (INCLUDE QUAD AND YEAR IN DESCRIPTION)	BM NUMBER
BASELINE (1995)	0034.363 0112.739	CS TRAV MON IN WELL ON C/L LONG BEACH BLVD 73M S/O C/L ROOSEVELT RD MKD (B-9 1940 RE 2177)	Y 7071
BASELINE (1995)	0030.455 0099.918	USC&GS MON FL 600MM W/O W CF LONG BEACH BL 11M W/O C/L & 6M S/O C/L COUNTRY CLUB LN (S ENT) NR LT STD #409 MKD (A-780 1946)	Y 7072
BASELINE (1995)	0028.826 0094.573	CS TRAV MON IN WELL 61M N/O C/L 44TH ST NR C/L LONG BEACH BLVD MKD (CLEARWATER B-8 RE 2177)	Y 7073
BASELINE (1995)	0012.945 0042.470	CS TRAV MON IN WELL 600MM E/O C/L LONG BEACH BL ON C/L ARBOR ST W MKD (CLEARWATER A-7 RE 2177)	Y 7074
BELLFLOWER (1995)	0021.272 0069.790	L&BN IN S CB CARSON ST 12.8M S/O C/L & 13.4M W/O C/L PROD DEEBOYER AVE (E/O UPRR TRACKS)	Y 7075
BASELINE (1995)	0022.670 0074.376	CS MON IN WELL 1.5M N/O N CF HAYFORD ST & 22.6M W/O C/L MC NAB ST MKD (BM 9-1A RE 5869 1961)	Y 7078
BASELINE (1995)	0019.447 0063.802	L&BN IN N CB 600MM E/O BCR @ NE COR ARTESIA BLVD & STUDEBAKER RD 25M E & 12.8M N/O C/L INT	Y 7080
BASELINE (1995)	0019.301 0063.323	L&BN IN CB RET 1.5M N BCR @ SW COR ARTESIA BLVD & STUDEBAKER RD 22M S & 13.1M W/O C/L INT	Y 7081
BASELINE (1995)	0013.758 0045.138	L&BN IN N CB 300MM E/O BCR @ NE COR CARSON ST & SAN ANSELIN AVE 16.5M E & 12.2M N/O C/L INT	Y 7087
BASELINE (1995)	0014.161 0046.460	CS MON IN WALK 12.2M E/O BCR @ NE COR LAKEWOOD BLVD & CARSON ST 32M E & 12.8M N/O C/L INT MKD (CLEARWATER G 9 A RM NO 6 RE 63 1954)	Y 7088
BASELINE (1995)	0015.697 0051.499	L&T IN S CB SOUTH ST 12.2M S/O C/L & 7.3M W/O C/L PROD OBISPO AVE	Y 7090
BASELINE (1995)	0015.969 0052.392	RDBM TAG IN S CB 11.6M W/O BCR @ SW COR SOUTH ST & DOWNEY AVE 30M W & 12.2M S/O C/L INT	Y 7091
BASELINE (1995)	0015.742 0051.647	L&T IN E CB S END C B 15.2M S/O BCR @ SE COR SOUTH ST & DOWNEY AVE 36M S & 9.4M E/O C/L INT	Y 7092
BASELINE (1995)	0016.905 0055.462	RDBM TAG IN W CB 900MM S/O BCR @ SW COR SOUTH ST & LAKEWOOD BLVD 24.4M S & 13.7M W/O C/L INT	Y 7093
BASELINE (1995)	0017.470 0057.316	L&BN IN W CB (SERV RD) 300MM S/O BCR @ SW COR HEDDA ST & LAKEWOOD BL 27M W & 14.3M S C/L INT	Y 7094
BASELINE (1995)	0017.506 0057.434	L&BR W CB (SERV RD) 300MM N BCR @ NW COR HEDDA ST & LAKEWOOD BLVD 27M W & 14.3M N/O C/L INT	Y 7095

JAD-YEAR	ELEV METER/FOOT	DESCRIPTION (INCLUDE QUAD AND YEAR IN DESCRIPTION)	BM NUMBER
BASELINE (1995)	0017.886 0058.681	L&BR W CB (SER RD) 1.5M N BCR @ SW COR LAKEWOOD BLVD & ASHWORTH ST 27.4M W & 12.2M S/O C/L INT	Y 7096
BASELINE (1995)	0017.771 0058.304	FC BR DISC IN E CB @ SE COR LAKEWOOD BLVD & ASHWORTH ST 17.4M E & 7M S/O C/L INT MKD (FC BM 74-230 1946)	Y 7097
BASELINE (1995)	0018.215 0059.760	L&T IN N CB ASHWORTH ST 5.5M N/O C/L & 5M W/O C/L PROD GRAYWOOD AVE	Y 7098
BASELINE (1995)	0018.505 0060.712	FC BR DISC IN E CB 1.5M N/O BCR @ NE COR CLARK AVE & ASHWORTH ST 14.3M N & 8.5M E/O C/L INT MKD (FC BM 120-20D)	Y 7100
BASELINE (1995)	0018.390 0060.335	L&BR IN N CB ASHWORTH ST 5.5M N/O C/L & 5.2M W/O C/L PROD LORELEI AVE	Y 7101
BASELINE (1995)	0018.377 0060.292	L&BN IN S CB 300MM E/O BCR @ SE COR LORELEI AVE & ASHWORTH ST 5.5M S & 12.8M E/O C/L INT	Y 7102
BASELINE (1995)	0018.414 0060.413	L&T IN N CB ASHWORTH ST 6.1M N/O C/L ON C/L PROD DUNROBIN AVE	Y 7103
BASELINE (1995)	0018.418 0060.426	L&BN IN S CB 300MM E/O BCR @ SE COR ASHWORTH ST & DUNROBIN AVE 12.5M E & 6.1M S/O C/L INT	Y 7104
BASELINE (1995)	0017.854 0058.576	L&T IN W CB 900MM S/O BCR @ SW COR PALO VERDE AVE & ALLINGTON AVE 21M S & 7.6M W/O C/L INT	Y 7106
BASELINE (1995)	0015.512 0050.892	L&T IN E CB 2.4M N/O BCR @ NE COR PARAMOUNT BL & CANDLEWOOD ST 22M N & 12.2M E/O C/L INT	Y 7108
BASELINE (1995)	0016.139 0052.949	RDBM TAG IN E CB 300MM S/O BCR @ SE COR SOUTH ST & PARAMOUNT BLVD 23M S & 12.2M E/O C/L INT	Y 7109
BASELINE (1995)	0021.789 0071.486	RDBM TAG IN S CB 300MM E BCR @ SE COR SOMERSET BL & GARFIELD AVE 23.2M E & 9.8M S/O C/L INT	Y 7772
BASELINE (1995)	0021.761 0071.394	RDBM TAG IN N CB 600MM W BCR @ NW COR SOMERSET BL & GARFIELD AVE 23.8M W & 9.1M N/O C/L INT	Y 7773
BASELINE (1995)	0016.941 0055.581	L&T IN E CB 10.7 E/O C/L LONG BEACH BLVD & 7.9M N/O C/L PROD 46TH ST	Y 8579
BASELINE (1995)	0017.434 0057.198	L&BR IN W CB (SER RD) 17.4M E/O C/L LONG BEACH BLVD ON C/L PROD 46TH ST (4.3M W/O C/L SERV RD)	Y 8580
BASELINE (1995)	0029.499 0096.781	L&RCE TAG #29861 NR CTR OF CB RET @ NE COR LONG BEACH BLVD (SERV RD) & 44TH ST 8.2M N & 8.2M E/O C/L INT OF (SERV RD)	Y 8581

JAD-YEAR	ELEV METER/FOOT	DESCRIPTION (INCLUDE QUAD AND YEAR IN DESCRIPTION)	BM NUMBER
BASELINE (1995)	0032.090 0105.282	RAMSET IN CHIS SQ W CB 900MM S/O BCR @ SW COR LONG BEACH BL & SAN ANTONIO DR 27.4M S & 11.3M W/O C/L INT	Y 8582
BASELINE (1995)	0034.339 0112.661	RAMSET IN W CB 1.5M S/O BCR @ SW COR LONG BEACH BLVD & ROOSEVELT RD 13.7M S & 12M W/O C/L INT	Y 8583
BASELINE (1995)	0029.852 0097.939	RDBM TAG IN W CB LONG BEACH BLVD 10.7M W/O C/L & 16.2M N/O C/L PROD 37TH ST	Y 8584
BASELINE (1995)	0025.280 0082.939	RDBM TAG IN S CB 1.2M W/O BCR @ SW COR WARDLOW RD & CALIFORNIA AVE 12.2M W & 8.5M S/O C/L INT	Y 8587
BASELINE (1995)	0025.000 0082.021	RDBM TAG IN E CB 1.8M N/O BCR @ NE COR WARDLOW RD & CALIFORNIA AVE 14.3M N & 4.9M E/O C/L INT	Y 8588
BASELINE (1995)	0020.111 0065.981	RDBM TAG IN N CB 9M E/O BCR @ NE COR WARDLOW RD & WALNUT AVE 24M E & 8.5M N/O C/L INT	Y 8590
BASELINE (1995)	0017.381 0057.024	L&BR IN W CB CHERRY AVE 12.2M W/O C/L & 9.1M N/O C/L PROD 32ND ST	Y 8591
BASELINE (1995)	0017.209 0056.460	CITY OF LB MON IN WELL ON C/L CHERRY AVE 9.1M N/O C/L 32ND ST MKD (1964 RE 3111)	Y 8592
BASELINE (1995)	0018.492 0060.669	L&BR IN E END C B 800MM W/O BCR @ SW COR SPRING ST & JUNIPERO AVE 18.6M W & 14M S/O C/L INT	Y 8594
BASELINE (1995)	0018.194 0059.691	L&BR IN S CB 300MM E/O BCR @ SE COR SPRING ST & JUNIPERO AVE 18.9M E & 14M S/O C/L INT	Y 8595
BASELINE (1995)	0007.994 0026.227	L&BR IN N CB 2.1M W/O BCR @ NW COR SPRING ST & RUTGERS AVE 12.8M N & 13.1M W/O C/L INT	Y 8599
BASELINE (1995)	0018.619 0061.086	RDBM TAG IN E CB 13.4M N BCR @ NE COR ASHWORTH ST & BELLFLOWER BLVD 29M N & 11.6M E/O C/L INT	Y 8756
BASELINE (1995)	0020.792 0068.215	RD BM TAG IN CB 300MM S/O BCR @ SW COR ATLANTIC AVE & COMPTON BLVD 11.6M W & 23.8M S/O C/L INT	Y 8757
BELLFLOWER (1995)	0020.233 0066.381	RDBM TAG IN W CB 11M N/O BCR @ NW COR ATLANTIC AVE & ALONDRA BLVD 34M N & 12.8M W/O C/L INT	Y 8758
BELLFLOWER (1995)	0020.336 0066.719	RDBM TAG IN S CB 300MM E/O BCR @ SE COR ALONDRA BLVD & ATLANTIC AVE 22M E & 12.2M S/O C/L INT	Y 8759
BELLFLOWER (1995)	0018.857 0061.867	RAMSET IN W CB 11.6M W/O C/L ATLANTIC AVE & 18.6M N/O C/L ATLANTIC PL (BETWEEN 2 C B'S)	Y 8760

JAD-YEAR	ELEV METER/FOOT	DESCRIPTION (INCLUDE QUAD AND YEAR IN DESCRIPTION)	BM NUMBER
BELLFLOWER (1995)	0018.939 0062.136	CLB BR DISC IN WK 600MM N BCR @ NE COR ATLANTIC AVE & ATLANTIC PL 15.2M N & 12M E/O C/L INT MKD (BM 1028 1967 RE 3111)	Y 8761
BELLFLOWER (1995)	0017.739 0058.199	CLB MON IN WELL 300MM DN @ C/L INT ATLANTIC AVE & ARTESIA BLVD MKD (RE 3111 1959)	Y 8762
BELLFLOWER (1995)	0017.650 0057.907	CLB MON IN WELL 300MM DN @ PI OF ATLANTIC AVE & 79M S/O C/L ARTESIA BLVD MKD (CLB RE 3111)	Y 8763
BELLFLOWER (1995)	0020.091 0065.915	USC&GS BR DISC MON FL IN S WALL OF W ABUT UPRR BRIDGE OVER ATLANTIC AVE 1.5M S/O C/L RR TRACKS MKD (C 789 1946)	Y 8768
BELLFLOWER (1995)	0017.800 0058.399	RDBM TAG IN W CB 900MM N/O BCR @ NW COR DEL AMO BLVD & ATLANTIC AVE 19.8M N & 12.2M W/O C/L INT	Y 8769
BELLFLOWER (1995)	0019.307 0063.343	CLB MON @ N END C B 1.5M S/O BCR @ SW COR DEL AMO BL & ORANGE AVE 21.3M S & 9.1M W/O C/L INT MKD (BM #155 1965)	Y 8771
BASELINE (1995)	0014.973 0049.124	L&BR IN S CB (DEPRESSED) 4.6M W/O BCR @ SW COR DEL AMO BLVD & PARAMOUNT BLVD 25M W & 12.8M S/O C/L INT	Y 8775
BASELINE (1995)	0015.068 0049.436	CSBM MON IN S END C B @ SW COR PARAMOUNT BLVD & DEL AMO BLVD 38M S & 11.9M W/O C/L INT MKD (BM 33-5A 1970 RE 5869)	Y 8776
BELLFLOWER (1995)	0017.529 0057.510	RDBM TAG IN S CB 600MM W/O BCR @ SW COR ARTESIA BLVD & SUSANA RD 25M W & 12.8M S/O C/L INT	Y 8777
BELLFLOWER (1995)	0017.508 0057.441	RAMSET IN S CB 1.2M E/O BCR @ SE COR ARTESIA BLVD & SUSANA RD 23M E & 12.8M S/O C/L INT	Y 8778
BELLFLOWER (1995)	0017.076 0056.024	RDBM TAG IN S CB 600MM W/O BCR @ SW COR ARTESIA BLVD & BUTLER AVE 12.8M S & 12.2M W/O C/L INT	Y 8779
BELLFLOWER (1995)	0017.084 0056.050	RDBM TAG IN S CB 600MM E/O BCR @ SE COR ARTESIA BLVD & BUTLER AVE 12.8M S & 12.2M E/O C/L INT	Y 8780
BELLFLOWER (1995)	0017.006 0055.794	RAMSET IN CB RET NR BCR @ NW COR ARTESIA BLVD & ORANGE AVE 20M N & 10M W/O C/L INT	Y 8781
BELLFLOWER (1995)	0017.107 0056.125	RAMSET IN S CB 2.7M E/O BCR @ SE COR ARTESIA BLVD & ORANGE AVE 17.7M E & 12.8M S/O C/L INT	Y 8782
BELLFLOWER (1995)	0017.391 0057.057	CLB MON 400MM W/O CF & 600MM W/O BCR @ SW COR CHERRY AVE & ARTESIA BL 19M W & 13M S/O C/L INT MKD (BM 150 1970 RE 3111)	Y 8783

JAD-YEAR	ELEV METER/FOOT	D E S C R I P T I O N (INCLUDE QUAD AND YEAR IN DESCRIPTION)	BM NUMBER
BELLFLOWER (1995)	0017.357 0056.945	RAMSET IN S CB 300MM E/O BCR @ SE COR ARTESIA BLVD & CHERRY AVE 19M E & 12.8M S/O C/L INT	Y 8784
BELLFLOWER (1995)	0008.907 0029.222	CS MON IN WELL ON C/L WARDLOW RD 450MM W/O NOSE ISLE 9M W C/L CHARLEMAGNE AVE MKD BM 32-12 1953	Y 8794
BELLFLOWER (1995)	0010.686 0035.059	CS MON IN WELL 450MM N CF 47M E & 9M N/O C/L INT CONANT ST & CHARLEMAGNE AVE MKD (BM 32-11 1953)	Y 8795
BASELINE (1995)	0018.078 0059.311	RDBM TAG IN W CB 300MM S BCR @ SW COR ASHWORTH ST & GRAYWOOD AVE 13.4M S & 4.6M W/O C/L INT	Y 8800
BASELINE (1995)	0015.657 0051.368	CLB MON IN WELL 200MM DN @ C/L INT PARAMOUNT BLVD & 55TH WAY (FR THE E) MKD (1964 RE 3111)	Y 8801
BASELINE (1995)	0015.342 0050.335	RDBM TAG IN S CB 300MM W BCR @ SW COR PARAMOUNT BLVD & CANDLEWOOD ST 24M W & 9.8M S/O C/L INT	Y 8802
BASELINE (1995)	0017.698 0058.064	RDBM TAG IN CB 2.1M S/O BCR @ SW COR PARAMOUNT BLVD (W SERV RD) & CENTRALIA ST 16.2M S & 4.3M W/O C/L SERV RD	Y 8803
BASELINE (1995)	0014.293 0046.893	RAMSET IN E CB 13.7M N/O BCR @ NE COR CARSON ST & LAKEWOOD BLVD 32M N & 12.8M E/O C/L INT	Y 8804
BASELINE (1995)	0012.438 0040.807	CLB MON IN E END C B 3M E/O BCR @ NE COR CLARK AVE & CARSON ST 16.5M E & 12.8M N/O C/L INT MKD (BM #555 1970 RE 3111)	Y 8805
BASELINE (1995)	0013.671 0044.852	RDBM TAG IN N CB 300MM W BCR @ NW COR CARSON ST & SAN ANSELIN AVE 12.2M N & 16.5M W/O C/L INT	Y 8806
BASELINE (1995)	0021.778 0071.450	RDBM TAG IN E CB 600MM N/O BCR @ NE COR 166TH ST & STUDEBAKER RD 22M N & 12.8M E/O C/L INT	Y 8808
BASELINE (1995)	0016.122 0052.894	CS MON IN W CB 13.7M N/O BCR @ NW COR SOUTH ST & STUDEBAKER RD 37M N & 13M W/O C/L INT MKD (BM 9-8C 1970 RE 5869)	Y 8810
BASELINE (1995)	0016.061 0052.693	RDBM TAG IN S CB 600MM W/O BCR @ SW COR SOUTH ST & STUDEBAKER RD 23M W & 12.8M S/O C/L INT	Y 8811
BASELINE (1995)	0016.256 0053.333	RDBM TAG IN S CB 600MM W/O BCR @ SE COR SOUTH ST & PALO VERDE AVE 19.8M E & 12.8M S/O C/L INT	Y 8812
BASELINE (1995)	0015.283 0050.141	L&T IN E CB 600MM S/O BCR @ SE COR PALO VERDE AVE & CANDLEWOOD ST 23M S & 9.1M E/O C/L INT	Y 8813
BASELINE (1995)	0008.784 0028.819	RDBM TAG IN S CB 300MM W/O BCR @ SE COR WARDLOW RD & PALO VERDE AVE 19.5M E & 12.2M S/O C/L INT	Y 8814

JAD-YEAR	ELEV METER/FOOT	D E S C R I P T I O N (INCLUDE QUAD AND YEAR IN DESCRIPTION)	BM NUMBER
BASELINE (1995)	0014.247 0046.742	CS MON IN C B 11M W/O BCR @ NW COR PALO VERDE AVE & DEL AMO BLVD 31M W & 13M N/O C/L INT MKD (BM 9-10A 1965 RE 5869)	Y 8815
LAKWOOD (1995)	0014.902 0048.891	CS MON IN WELL 200MM DN 5.2M E/O BCR & 2.7M N/O N CF @ NE COR DEL AMO BLVD & CLARK AVE 25.6M E & 5M N/O C/L INT MKD (BM 32-7B 1961 RE 5869)	Y 8816
LAKWOOD (1995)	0017.279 0056.690	RDBM TAG IN S CB RET NR BCR @ SE COR BELLFLOWER BLVD & SOUTH ST 23M E & 14M S/O C/L INT	Y 8825
LAKWOOD (1995)	0016.940 0055.577	RDBM TAG IN S CB 13.4M W/O BCR @ SW COR SOUTH ST & WOODRUFF AVE 35.4M W & 12.2M S/O C/L INT	Y 8827
LAKWOOD (1995)	0016.924 0055.525	RDBM TAG IN S CB 300MM E/O BCR @ SE COR SOUTH ST & WOODRUFF AVE 23M E & 12.2M S/O C/L INT	Y 8828
LAKWOOD (1995)	0016.754 0054.967	L&BR IN N CB SOUTH ST 12M N/O C/L ON C/L PROD SNOWDEN AVE	Y 8829
BASELINE (1995)	0021.497 0070.528	CS MON IN WELL 5.2M N/O CF 740MM W/O BCR @ NE COR ALONDRA BLVD & CLARK AVE 16.8M N & 15.8M E/O C/L INT MKD (BM 6-8A 1970 RE 5869)	Y 9285
BASELINE (1995)	0021.912 0071.890	LS TAG #2428 IN N CB 3.4M W BCR @ NW COR ALONDRA BLVD & VIRGINIA AVE 16.5M W & 12.2M N/O C/L INT	Y 9286
BASELINE (1995)	0021.776 0071.443	RAMSET IN CB RET 2.2M W/O BCR @ NE COR ALONDRA BLVD & LAKEWOOD BLVD 17.4M E & 12.8M N/O C/L INT	Y 9287
BASELINE (1995)	0021.438 0070.335	L&BR IN CB RET 600MM E/O BCR @ NW COR ALONDRA BLVD & PITTS AVE 12.8M N & 12M W/O C/L INT	Y 9288
BASELINE (1995)	0020.868 0068.464	CS MON IN WELL 300MM B/W @ NE COR ALONDRA BLVD & DOWNEY AVE 18M E & 15.5M N/O C/L INT MKD (BM 6-10A 1970 RE 5869)	Y 9289
BASELINE (1995)	0021.701 0071.197	L&BN IN W CB 1.8M N/O BCR @ NW COR ALONDRA BL & ORIZABA AVE 22M N & 8.5M W/O C/L INT	Y 9290
BASELINE (1995)	0022.747 0074.629	CS BM MON IN WELL 225MM DN 600MM B/W @ CTR CB RET SW COR SOMERSET BL & PARAMOUNT BL 17.1M W & 15.2M S/O C/L INT MKD (BM 6-13A 1970 RE 5869)	Y 9293
BASELINE (1995)	0021.923 0071.926	L&BR IN CTR CB RET @ SE COR MINNESOTA AVE & SOMERSET BLVD 11M S & 13.1M E/O C/L INT	Y 9302
BASELINE (1995)	0021.652 0071.037	CS BM MON IN WELL 300MM B/K @ W EDGE OF DRWY TO FIRE STA #31 64M E & 12.5M N/O C/L INT SOMERSET BL & GARFIELD AVE MKD (BM 6-14A RE 5869)	Y 9304

JAD-YEAR	ELEV METER/FOOT	D E S C R I P T I O N (INCLUDE QUAD AND YEAR IN DESCRIPTION)	BM NUMBER
BASELINE (1995)	0021.795 0071.506	L&T IN N CB NR E END C B @ NE COR SOMERSET BL & TEXACO AVE (TO THE N) 9.1M N & 17.7M E/O C/L INT	Y 9305
BASELINE (1995)	0021.931 0071.952	L&T IN S CB 300MM W BCR @ SW COR SOMERSET BL & TEXACO AVE (TO THE S) 18.6M W & 9.8M S/O C/L INT	Y 9306
BASELINE (1995)	0027.639 0090.679	FC MON IN E ABUT @ SE COR BRIDGE OVER LA RIVER 9.8M S/O C/L SOMERSET BL MKD (BM 4-26)	Y 9308
BASELINE (1995)	0021.568 0070.761	L&BN IN S CB COMPTON BL 12.5M S/O C/L & 3.4M W/O C/L PROD HARRIS AVE (TO THE N)	Y 9311
BASELINE (1995)	0021.538 0070.663	L&BN IN N CB 300MM W/O BCR @ NW COR COMPTON BL & HARRIS AVE (TO THE N) 11M W & 9.8M N/O C/L INT	Y 9312
BASELINE (1995)	0028.646 0093.983	FC MON IN WALK 1.3M S/O S CF @ SW COR OF BRIDGE OVER SAN GABRIEL RIVER 12.5M S/O C/L ALONDRA BL MKD (BM 075-00877 1974)	Y 9375
BASELINE (1995)	0028.060 0092.060	PK NAIL IN S CB @ SE END BRIDGE #B977 OVER SAN GABRIEL RIVER 11.3M S/O C/L ALONDRA BLVD	Y 9376
BASELINE (1995)	0022.939 0075.259	CS MON IN S WALL C B 10.4M N/O BCR @ NW COR ALONDRA BLVD & STUDEBAKER RD 33.5M N & 13M W/O C/L INT MKD (BM 9-3C 1975 RE 7078)	Y 9377
BASELINE (1995)	0022.627 0074.235	L&BR IN CTR OF CB RET @ SE COR ALONDRA BLVD & STUDEBAKER RD 16.2M E & 16.2M S/O C/L INT	Y 9378
BASELINE (1995)	0022.166 0072.723	RDBM TAG IN E CB 900MM S/O BCR @ SE COR FALCON WAY & STUDEBAKER RD 15.2M S & 12.8M E/O C/L INT (ENT RD TO CERRITOS COLLEGE)	Y 9379
BASELINE (1995)	0020.120 0066.010	RDBM TAG IN S WALL C B 7.3M N/O BCR @ NE COR STUDEBAKER RD & ON-RAMP TO ARTESIA FWY (91) E BOUND 13M N & 13M E/O C/L INT	Y 9381
BASELINE (1995)	0019.290 0063.287	CS BM MON IN E WALL C B 23M W/O BCR @ NW COR ARTESIA BLVD & STUDEBAKER RD 46M W & 14.3M N/O C/L INT MKD (BM 9-6C 1965 RE 5869)	Y 9382
BASELINE (1995)	0017.687 0058.028	CS BM MON IN S WALL C B 1.5M N/O BCR @ NW COR STUDEBAKER RD & 183RD ST 21M N & 13.1M W/O C/L INT MKD (BM 9-7B 1975 RE 7078)	Y 9383
BASELINE (1995)	0021.931 0071.952	FC MON IN WALK @ SW END BRIDGE #B972 OVER SAN GABRIEL RIVER 12.8M S/O C/L SOUTH ST MKD (BM 074-02797 1974)	Y 9385

JAD-YEAR	ELEV METER/FOOT	D E S C R I P T I O N (INCLUDE QUAD AND YEAR IN DESCRIPTION)	BM NUMBER
BASELINE (1995)	0012.819 0042.057	RDBM TAG IN W CB 900MM S/O BCR @ SW COR ARBOR RD & PALO VERDE AVE 17.7M S & 9.1M W/O C/L INT	Y 9386
BASELINE (1995)	0008.397 0027.549	CLB MON IN WELL @ C/L INT WARDLOW RD & PALO VERDE AVE MKD (C L B 1958 RE 3111)	Y 9387
BASELINE (1995)	0008.053 0026.421	RAMSET IN E CB 300MM S/O BCR @ SE COR PALO VERDE AVE & METZ ST 17.4M S & 9.1M E/O C/L INT	Y 9388
BASELINE (1995)	0008.461 0027.759	FC MON IN W CB 16.5M S/O BCR @ SW COR 41.8M S/O C/L SPRING ST & 11.3M W/O C/L LOS COYOTES DIAG MKD (BM 120-81 1961)	Y 9389
BELFLOWER (1995)	0007.723 0025.338	CITY LB MON IN WELL 200MM DN @ C/L INT SPRING ST & CHARLEMAGNE AVE MKD (C L B 1968 RE 3111)	Y 9391
BASELINE (1995)	0020.348 0066.758	L&BR IN N CB 5.2M W/O BCR @ NW COR WARDLOW RD & WALNUT AVE 15.2M W & 8.5M N/O C/L INT	Y 9395
BASELINE (1995)	0009.626 0031.581	L&BN @ BCR SE COR PALO VERDE AVE & HARCO ST 17.7M S & 9.1M E/O C/L INT	Y 9396
BASELINE (1995)	0017.294 0056.739	L&RCE TAG #2795 IN E CB @ BCR NE COR ANDY ST & PALO VERDE AVE 16.8M N & 9.8M E/O C/L INT	Y 9397
BASELINE (1995)	0012.394 0040.663	LRG PK NR SLY END OF E WINGWALL CONC BRIDGE OPP HSE #5147 CARSON ST 15.5M S/O C/L & 59M E/O C/L GREENBRIER RD (3M S/O SLY CF)	Y 9401
BELFLOWER (1995)	0021.224 0069.632	CLB MON 2.1M E/O BCR @ NE COR CARSON ST & CHERRY AVE 24M E & 13.7M N/O C/L INT MKD (CLB 444 1972)	Y 9416
BELFLOWER (1995)	0017.818 0058.458	CLB MON IN E CB 300MM N/O BCR @ NE COR 63RD ST & PARAMOUNT BLVD 12.2M N & 12.2M E/O C/L INT MKD (BM 1172 1966 RE 3111)	Y 9419
BELFLOWER (1995)	0019.386 0063.602	RAMSET IN S CB 3.7M E/O BCR @ SE COR PARAMOUNT BLVD & 68TH ST 21M E & 6.1M S/O C/L INT	Y 9420
BELFLOWER (1995)	0019.177 0062.917	RDBM TAG IN N CB 600MM E/O BCR @ NE COR DEL AMO BLVD & ORANGE AVE 15.2M E & 12.8M N/O C/L INT	Y 9432
BELFLOWER (1995)	0009.072 0029.764	RDBM TAG S END C B 2M N/O BCR @ NW COR WARDLOW RD & CHARLEMAGNE AVE 22M N & 18FT W/O C/L INT	Y 9434
BELFLOWER (1995)	0012.095 0039.682	L&T IN N CB NR CTR OF CURVE CHARLEMAGNE AVE 5M NLY/O C/L & 2.5M ELY/O C/L PROD PT PARKCREST ST	Y 9436
BELFLOWER (1995)	0012.157 0039.885	L&N IN S CB RET 900MM E BCR @ SW COR PARKCREST ST & CHARLEMAGNE AVE 23.5M W & 4.6M S/O C/L INT	Y 9437

JAD-YEAR	ELEV METER/FOOT	DESCRIPTION (INCLUDE QUAD AND YEAR IN DESCRIPTION)	BM NUMBER
BASELINE (1995)	0017.679 0058.002	RDBM TAG NR W END C B IN S CB (SERV RD) CARSON ST & LEVELSIDE AVE 18.3M N & 1.5M E/O C/L PROD	Y 9534
BASELINE (1995)	0017.708 0058.097	RDBM TAG IN N CB 300MM W/O BCR @ NW COR CARSON ST (SERV RD) & LEVELSIDE AVE 13.4M W & 4.3M N/O C/L INT (SERV RD)	Y 9535
BASELINE (1995)	0019.105 0062.680	RD TAG IN E CB 300MM N/O BCR @ NE COR CARSON ST & PARAMOUNT BLVD 24M N & 12.8M E/O C/L INT	Y 9536
BASELINE (1995)	0019.181 0062.930	RD TAG @ SW COR CARSON ST & PARAMOUNT BLVD 42FT S & 68FT W/O C/L INT (1FT W/O BCR)	Y 9537
BASELINE (1995)	0007.663 0025.141	RDBM TAG IN E CB 3.7M S/O BCR @ SE COR WOODRUFF AVE & SPRING ST 23M S & 13.4M E/O C/L INT	Y 9539
BASELINE (1995)	0007.271 0023.855	RDBM TAG IN N CB 300MM W/O BCR @ NW COR SPRING ST & PALO VERDE AVE 17.7M W & 12.8M N/O C/L INT	Y 9540
BASELINE (1995)	0007.457 0024.465	RDBM TAG IN N CB 300MM E/O BCR @ NE COR SPRING ST & PALO VERDE AVE 17.7M E & 12.8M N/O C/L INT	Y 9541
BELLFLOWER (1995)	0016.772 0055.026	RDBM TAG IN N END OF C B 3M N/O BCR @ NW COR ATLANTIC AVE (SERV RD) & HARDING ST 20M N & 26M W/O C/L INT	Y 9646
BELLFLOWER (1995)	0015.614 0051.227	RDBM TAG IN WALK 12.5M N/O BCR 4.5M W/O CF @ NW COR ATLANTIC AVE & SOUTH ST 26.5M N & 14.6M W/O C/L INT	Y 9648
BELLFLOWER (1995)	0017.560 0057.611	CLB MON IN WK 300MM W/O BCR @ NW COR CHERRY AVE & DEL AMO BLVD 33M W & 17.7M N/O C/L INT MKD (CLB BM 1979)	Y 10061
BELLFLOWER (1995)	0017.765 0058.284	L&T IN N CB 16.8M E/O BCR @ NE COR CHERRY AVE & DEL AMO BLVD 46.3M E & 12.8M N/O C/L INT	Y 10062
BASELINE (1995)	0007.780 0025.525	CLB MON FL 2.4M W/O BCR 300MM N/O CF @ NW COR SPRING ST & CHARLEMAGNE AVE 12.8M N & 13.4M W/O C/L INT MKD (RE 3111 1033 CLB 1969)	Y 10064
BASELINE (1995)	0012.328 0040.446	L&BR IN CTR CB RET @ NE COR DEL AMO BLVD & ALAMEDA ST (W BBL) 13.7M E & 16.8M N/O C/L INT	Y 10102
BASELINE (1995)	0014.798 0048.550	LS TAG #2760 IN CB NR C/L PROD LAUREL PARK RD (FR THE WEST) IN E CB ALAMEDA ST (W BBL)	Y 10138
BASELINE (1995)	0018.944 0062.152	RDBM TAG IN CB 600MM N BCR @ NE COR ALAMEDA ST (W BBL) & AUTO DR S 19.8M N & 12.2M E/O C/L INT	Y 10139

JAD-YEAR	ELEV METER/FOOT	D E S C R I P T I O N (INCLUDE QUAD AND YEAR IN DESCRIPTION)	BM NUMBER
BASELINE (1995)	0020.349 0066.762	L&T IN N CB 1.5M E/O BCR @ NE COR ALONDRA BLVD & ALAMEDA ST (W BBL) 15.2M E & 9.1M N/O C/L INT	Y 10140
BASELINE (1995)	0020.335 0066.716	DPW BM TAG IN S CB 300MM W BCR @ SW COR COMPTON BL & SANTA FE AVE 23.8M W & 12.8M S/O C/L INT	Y 10211
BASELINE (1995)	0020.432 0067.034	DPW BM TAG IN N CB 300MM E BCR @ NW COR COMPTON BL & SANTA FE AVE 23.5M W & 12.8M N/O C/L INT	Y 10212
BASELINE (1995)	0020.907 0068.592	DPW BM TAG IN S CB 300MM W BCR @ SW COR COMPTON BL & BURRIS AVE 12.8M S 8.5M W/O C/L INT	Y 10213
BASELINE (1995)	0020.935 0068.684	DPW BM TAG IN CB RET 3.4M W BCR @ NE COR BURRIS AVE & COMPTON BL 13.7M N & 8.5M E/O C/L INT	Y 10214
BASELINE (1995)	0020.870 0068.471	DPW BM TAG IN S CB 300MM E BCR @ SE COR COMPTON BL & ATLANTIC AVE 19.2M E & 9.1M S/O C/L INT	Y 10215
BASELINE (1995)	0021.570 0070.768	DPW BM TAG IN N CB 300MM E BCR @ NW COR COMPTON BLVD & GIBSON AVE 14M W & 10.7M N/O C/L INT	Y 10216
BASELINE (1995)	0021.789 0071.486	DPW BM TAG IN E CB 300MM S BCR @ SE COR ORANGE AVE & SOMERSET BLVD 20.7M S 9.8M E/O C/L INT	Y 10218
BASELINE (1995)	0022.026 0072.264	RD BM TAG IN S CB 300MM W BCR @ SW COR SOMERSET BL & MINNESOTA AVE 13.7M W & 9.8M S/O C/L INT	Y 10219
BASELINE (1995)	0021.530 0070.636	RDBM TAG IN S CB 2.4M W/O BCR @ SE COR ALONDRA BLVD & PARAMOUNT BLVD 21M E & 13M S/O C/L INT	Y 10222
BASELINE (1995)	0021.195 0069.537	DPW BM TAG IN S CB 300MM W BCR @ SW COR HAYTER AVE & ALONDRA BLVD 12.8M S & 7.6M W/O C/L INT	Y 10223
BASELINE (1995)	0021.863 0071.729	DPW BM TAG IN N CB 300MM E BCR @ NE COR ALONDRA BLVD & VIRGINIA AVE 15.5M E & 12.8M N/O C/L INT	Y 10224
BASELINE (1995)	0010.367 0034.012	DPW BM TAG IN W END C B 8M N/O C/L DOMINGUEZ ST & 13.4M E/O C/L PROD PROSPECT AVE	Y 10228
BASELINE (1995)	0017.127 0056.191	DPW BM TAG IN E CB 300MM E/O BCR @ NE COR CHERRY AVE & WARDLOW RD 15.2M N & 13.7M E/O C/L INT	Y 10229
BASELINE (1995)	0017.163 0056.309	DPW BM TAG IN E CB 300MM S BCR @ SE COR CHERRY AVE & WARDLOW RD 14.3M S & 13.7M E/O C/L INT	Y 10230
BASELINE (1995)	0007.561 0024.806	DPW BM TAG IN N CB (SERV RD) SPRING ST 300MM E/O BCR 14M E/O C/L RUTGERS AVE & 4.3M N/O C/L (SERV RD)	Y 10233

JAD-YEAR	ELEV METER/FOOT	D E S C R I P T I O N (INCLUDE QUAD AND YEAR IN DESCRIPTION)	BM NUMBER
BASELINE (1995)	0007.793 0025.568	RAM SET IN N CB 1.8M E/O BCR @ NE COR SPRING ST & WOODRUFF AVE 23M E & 14.6M N/O C/L INT	Y 10234
BASELINE (1995)	0008.848 0029.029	DPW BM TAG IN W CB 300MM N/O BCR @ NW COR PALO VERDE AVE & WARDLOW RD 24M N & 9.1M W/O C/L INT	Y 10236
BASELINE (1995)	0012.077 0039.623	L&BN IN E CB 300MM S/O BCR @ SE COR CENTRALIA ST & PALO VERDE AVE 17.4M S & 9.4M E/O C/L INT	Y 10237
BASELINE (1995)	0017.648 0057.900	L&BR IN CB RET 5.5M N/O BCR @ SW COR STUDEBAKER RD & 183RD ST 15.2M S & 15.2M W/O C/L INT	Y 10238
BELLFLOWER (1995)	0019.175 0062.910	CLB BR DISC 300MM W/O BCR @ NW COR ARTESIA BL & PARAMOUNT BL 20M W & 14M N C/L INT MKD (BM 1981)	Y 10325
BELLFLOWER (1995)	0019.186 0062.946	DPW BM TAG IN E CB 300MM N BCR @ NE COR ARTESIA BL & PARAMOUNT BLVD 21M N & 13.7M E/O C/L INT	Y 10326
BELLFLOWER (1995)	0020.729 0068.008	DPW BM TAG W CB 300MM S/O BCR @ SW COR JACKSON ST & PARAMOUNT BLVD 16.8M S & 12.8M W/O C/L INT	Y 10327
BELLFLOWER (1995)	0020.729 0068.008	DPW BM TAG W CB 300MM N/O BCR @ NW COR JACKSON ST & PARAMOUNT BL 16.8M N C/L 12.8M W/O C/L INT	Y 10328
BELLFLOWER (1995)	0015.551 0051.020	DPW BM TAG IN CB RET 300MM W BCR @ SE COR SOUTH ST & ATLANTIC AVE 15.2M E & 9M S/O C/L INT	Y 10356
BELLFLOWER (1995)	0017.443 0057.228	DPW BM TAG IN E CB 1.5M N/O BCR @ NE COR DEL AMO BL & ATLANTIC AVE 27M N & 12.2M E/O C/L INT	Y 10358
BASELINE (1995)	0012.333 0040.463	DPW BM TAG IN S CB 3M E BCR @ SE COR DEL AMO BL & ALAMEDA ST (W BBL) 13.7M S & 11.3M E/O C/L INT	Y 10499
BASELINE (1995)	0021.556 0070.722	LA CO BM TAG IN W CB 7.6M S BCR @ SW COR GIBSON AVE & COMPTON BLVD 24.7M S & 6.1M W/O C/L INT	Y 10800
BASELINE (1995)	0021.724 0071.273	DPW BM TAG IN E CB 1M N/O BCR @ NE COR SOMERSET BL & ORANGE AVE 21.6M N & 9.8M E/O C/L INT	Y 10844
BASELINE (1995)	0021.727 0071.283	DPW BM TAG IN N CB 1M W/O BCR @ NW COR SOMERSET BL & SAN JOSE AVE 10.4M N & 14.6M W/O C/L INT	Y 10845
BASELINE (1995)	0021.105 0069.242	DPW BM TAG IN N CB 1M W/O BCR @ NW COR COMPTON BL & LONG BEACH BL 12.8M N & 21.6M W/O C/L INT	Y 10846
BASELINE (1995)	0010.388 0034.081	DPW BM TAG IN E CB 1M N BCR @ NE COR ALAMEDA ST (E BBL) & DOMINGUEZ ST 16.8M N & 11.6M E C/L INT	Y 10850

JAD-YEAR	ELEV METER/FOOT	DESCRIPTION (INCLUDE QUAD AND YEAR IN DESCRIPTION)	BM NUMBER
BASELINE (1995)	0015.181 0049.806	50MM BR DISC IN W CB ALAMEDA ST (E BBL) 13.4M W/O C/L & 9.1M S/O C/L PROD SANTA FE AVE MKD (LACTC 0126 LS 3258)	Y 10890
BASELINE (1995)	0015.265 0050.082	L&BN IN W CB ALAMEDA ST (E BBL) 13.4M W/O C/L & 3.4M N/O C/L PROD SANTA FE AVE	Y 10891
BASELINE (1995)	0011.178 0036.673	DPW BM TAG IN N END C B 12.8M W/O C/L SANTA FE AVE & 12M N/O C/L DRWY TO BLDG #20851 (25M N/O RR TRACK CROSSING)	Y 11050
BASELINE (1995)	0011.760 0038.583	L&BN IN W END C B 3.4M W/O BCR @ SW COR SANTA FE AVE & DEL AMO BL 28M W & 12.8M S/O C/L INT	Y 11051
BASELINE (1995)	0012.016 0039.422	DPW BM TAG IN N CB 3M E/O BCR @ NE COR DEL AMO BLVD & SANTA FE AVE 27.7M E & 12.8M N/O C/L INT	Y 11052
BASELINE (1995)	0012.864 0042.205	SM SPK IN E CB 200MM N/O BCR @ NE COR DEL AMO BLVD & SUSANA RD 23.8M N & 12.2M E/O C/L INT	Y 11053
BASELINE (1995)	0017.621 0057.812	L&BR IN S CB 3.3M W/O WLY ABUT @ SW COR BRIDGE OVER LA RIVER 12.8M S/O C/L DEL AMO BLVD	Y 11054
BASELINE (1995)	0017.748 0058.228	FC BR DISC IN E ABUT @ SE COR BRIDGE OVER LA RIVER 600MM S/O SLY CF 13.4M S/O C/L DEL AMO BLVD MKD (FCBM 003-00530 1962)	Y 11055
BASELINE (1995)	0012.333 0040.463	DPW BM TAG IN S CB 4M E/O BCR @ SE COR DEL AMO BLVD & PACIFIC AVE 15.8M E & 14.6M S/O C/L INT	Y 11056
BASELINE (1995)	0013.182 0043.248	DPW BM TAG IN W CB 12.5M S/O BCR @ SW COR DEL AMO BL & LONG BEACH BL 30M S & 10.7M W C/L INT	Y 11057
BASELINE (1995)	0013.192 0043.281	DPW BM TAG IN E CB 12.5M S/O BCR @ SE COR DEL AMO BLVD & LONG BEACH BLVD 39M S & 10.7M E/O C/L INT (@ F HYD)	Y 11058
BASELINE (1995)	0032.585 0106.906	L&T IN E CB 1M S/O BCR @ SW COR LONG BEACH BLVD & MARSHALL PL 10.4M S & 10.7 M W/O C/L INT	Y 11059
BASELINE (1995)	0027.705 0090.895	L&BR IN W CB 1.4M S/O BCR @ SW COR ATLANTIC AVE & WARDLOW RD 14.3M S & 9.1M W/O C/L INT	Y 11060
BASELINE (1995)	0018.424 0060.446	CLB BR DISC FL IN CONC C/L MEDIAN CHERRY AVE 1M S/O N BRIDGE ABUT OVER (405 FRWY) MKD (BM 454 1963 RE 3111)	Y 11061
BASELINE (1995)	0024.015 0078.789	DPW BM TAG IN W CB 1M N/O BCR @ NW COR CHERRY AVE & SPRING ST 13.7M W & 24.7M N/O C/L INT	Y 11062

JAD-YEAR	ELEV METER/FOOT	D E S C R I P T I O N (INCLUDE QUAD AND YEAR IN DESCRIPTION)	BM NUMBER
BASELINE (1995)	0011.273 0036.985	DPW BM TAG IN S CB 3M E/O BCR @ SE COR SPRING ST & REDONDO AVE 13.4M S & 22.3M E/O C/L INT	Y 11063
BASELINE (1995)	0010.603 0034.787	DPW BM TAG IN S CB 1M W BCR @ SW COR SPRING ST & KILROY AIRPORT WAY 13.7M S & 17.4M W/O C/L INT	Y 11064
BASELINE (1995)	0004.011 0013.159	DPW BM TAG IN S CB 2M W/O WLY EDGE OF OVERPASS MAIN RUNWAY LB AIRPORT 9.1M S/O C/L SPRING ST NR CTR OF C B (@ F HYD)	Y 11065
BASELINE (1995)	0003.660 0012.008	DPW BM TAG IN S CB OF C/L MEDIAN 750MM S/O C/L SPRING ST & 5M E/O ELY EDGE OVERPASS MAIN RUNWAY LB AIRPORT	Y 11066
BASELINE (1995)	0008.624 0028.294	DPW BM TAG IN N CB 2M W/O BCR @ NW COR SPRING ST & LAKEWOOD BLVD 37.5M W & 12.2M N/O C/L INT	Y 11067
BASELINE (1995)	0008.407 0027.582	DPW BM TAG IN S CB 1M E/O BCR @ SE COR SPRING ST & LAKEWOOD BLVD 34M E & 12.2M S/O C/L INT	Y 11068
BASELINE (1995)	0008.688 0028.504	NGS BR DISC IN W CB 780MM N/O BCR @ SW COR CLARK AVE & SPRING ST 18.9M S & 12.8M W/O C/L INT MKD (X-1329 1978)	Y 11069
BASELINE (1995)	0008.030 0026.345	RAM SET IN CHIS SQ SE COR C B 5.5M N/O BCR @ NE SPRING ST & CLARK AVE 32M N & 13.7M E/O C/L INT	Y 11070
BASELINE (1995)	0009.154 0030.033	L&BN IN E CB 1M S/O BCR @ SE COR PALO VERDE AVE & KEYNOTE ST 16.8M S & 9.1M E/O C/L INT (NR C B)	Y 11071
BASELINE (1995)	0010.022 0032.881	CLB BR DISC IN CONC PAD 320MM N CF & 300MM E/O BCR NE COR PALO VERDE AVE & CONANT ST 21M E & 5.8M N/O C/L INT MKD (BM 1981)	Y 11072
BASELINE (1995)	0009.759 0032.018	CLB BR DISC IN CONC PAD 320MM N/O CF & 5.8M W/O BCR @ NE COR PALO VERDE AVE & HARCO ST 15.5M E & 7.3M N/O C/L INT MKD (BM 1981)	Y 11073
BASELINE (1995)	0016.160 0053.018	L&T IN W CB @ C B 1M N/O BCR NW COR PALO VERDE AVE & SOUTH ST 23M N & 9.8M W/O C/L INT	Y 11074
BASELINE (1995)	0016.912 0055.485	L&T IN E CB 5.5M S/O BCR @ SE COR STUDEBAKER RD & AUTO SQUARE DR 19.5M S & 15.5M E/O C/L INT	Y 11075
BASELINE (1995)	0018.580 0060.958	DPW BM TAG IN E CB STUDEBAKER RD 12.8M E/O C/L & 10.4M S/O C/L DRWY TO BLDG #17720 (@ PP)	Y 11076
BASELINE (1995)	0023.735 0077.871	DPW BM TAG IN E CB 1M N/O BCR @ NE COR ALONDRA BLVD & EUCALPTUS ST 17.4M N & 6.1M E/O C/L INT	Y 11077

JAD-YEAR	ELEV METER/FOOT	DESCRIPTION (INCLUDE QUAD AND YEAR IN DESCRIPTION)	BM NUMBER
BASELINE (1995)	0020.802 0068.248	DPW BM TAG IN N CB 13.7M W/O BCR NR E END C B @ NW COR ALONDRA BLVD & DOWNEY AVE 34M W & 13.4M N/O C/L INT	Y 11078
BASELINE (1995)	0021.513 0070.581	DPW BM TAG IN E CB 3M N/O BCR @ NE COR ALONDRA BLVD & PARAMOUNT BLVD 27M N & 12.8M E/O C/L INT	Y 11079
BASELINE (1995)	0022.162 0072.710	DPW BM TAG IN W CB 1M N/O BCR @ NW COR PARAMOUNT BLVD & JEFFERSON ST 17.4M N & 10.7M W/O C/L INT	Y 11080
BASELINE (1995)	0014.460 0047.441	L&BR IN N CB 14.6M E/O BCR @ NE COR CARSON ST & WOODRUFF AVE 38M E & 12.2M N/O C/L INT	Y 11083
BASELINE (1995)	0012.632 0041.443	DPW BM TAG IN W CB 18.3M N BCR @ NE COR CARSON ST & BELLFLOWER BLVD 41M N & 12.2M W/O C/L INT	Y 11084
BASELINE (1995)	0012.514 0041.056	DPW BM TAG IN N CB E END C B 3M E/O BCR @ NE COR CARSON ST & CHARLEMAGNE AVE 18M E & 12.2M N/O C/L INT	Y 11085
BASELINE (1995)	0012.443 0040.823	DPW BM TAG IN W CB 300MM N/O BCR @ NW COR CLARK AVE & CARSON ST 19M N & 9.8M W/O C/L INT	Y 11086
BASELINE (1995)	0013.088 0042.940	DPW BM TAG IN N CB CARSON ST 12.5M N/O C/L @ BLDG #4551 (@ ST LT #E206)	Y 11087
BASELINE (1995)	0015.870 0052.067	DPW BM TAG IN N CB 1.2M W/O BCR @ NW COR CARSON ST & LAKEWOOD BLVD 13.7M W & 11.6M N/O C/L INT	Y 11088
BASELINE (1995)	0018.138 0059.508	FC BR DISC IN E END CHANNEL HDWL 9M S/O C/L ASHWORTH ST & E/O HSE #5138 MKD BM 120-114 1961	Y 11089
BASELINE (1995)	0018.321 0060.108	L&BN IN N CB 1.3M W/O BCR @ NW COR ALLINGTON ST & CARPINTERO AVE 15.3M W & 9M N/O C/L INT	Y 11090
BELLFLOWER (1995)	0017.806 0058.419	CLB BR DISC IN WK 600MM E/O BCR @ NW COR CHERRY AVE (SERV RD) & 36TH ST 10.4M W & 6M N/O C/L INT MKD (BM 429 1975 RE 9675)	Y 11091
BELLFLOWER (1995)	0021.180 0069.488	DPW BM TAG IN S CB 12M E/O BCR @ SE COR CARSON ST & CHERRY AVE 38M E & 12.5M S/O C/L INT	Y 11092
BELLFLOWER (1995)	0017.408 0057.113	DPW BM TAG IN E CB PARAMOUNT BLVD 12.2M E/O C/L & 9.1M N/O C/L DRWY TO HSE #6172	Y 11093
BELLFLOWER (1995)	0016.374 0053.720	DPW BM TAG IN N CB (SERV RD) 1M E/O BCR @ NE COR DEL AMO BLVD & DEEBOYAR AVE 15M E & 4.3M N/O C/L INT (SERV RD)	Y 11094

JAD-YEAR	ELEV METER/FOOT	DESCRIPTION (INCLUDE QUAD AND YEAR IN DESCRIPTION)	BM NUMBER
BELLFLOWER (1995)	0013.227 0043.396	DPW BM TAG IN W CB 1M N/O BCR @ NW COR ATLANTIC AVE & 52ND ST 11M N & 10.4M W/O C/L INT	Y 11095
BELLFLOWER (1995)	0014.176 0046.509	CLB BR DISC IN WK 200MM S/O BCR @ SW COR MARKET ST & ATLANTIC AVE 14M S & 10M W/O C/L INT	Y 11096
BELLFLOWER (1995)	0014.169 0046.486	DPW BM TAG IN S CB 300MM E/O BCR @ SE COR MARKET ST & ATLANTIC AVE 14M E & 7.6M S/O C/L INT	Y 11097
BELLFLOWER (1995)	0016.027 0052.582	DPW BM TAG IN E CB 1M N/O BCR @ NE COR 60TH ST & ATLANTIC AVE 10.4M N & 10M E/O C/L INT	Y 11098
BELLFLOWER (1995)	0016.685 0054.741	RDBM TAG IN W CB 600MM S/O BCR @ SW COR ATLANTIC AVE & HARDING ST 15M S & 12.5M W/O C/L INT	Y 11099
BELLFLOWER (1995)	0017.356 0056.942	DPW BM TAG IN W CB 1M N/O BCR @ NW COR 64TH ST & ATLANTIC AVE (SERV RD) 14M N & 5.8M W/O C/L	Y 11100
BELLFLOWER (1995)	0023.403 0076.781	US ENGR DEPT 100MM BR DISC IN WINGWALL @ SE COR BRIDGE OVER LA RIVER 8.2M E/O C/L ATLANTIC AVE MKD (H F 8 1948)	Y 11101
BELLFLOWER (1995)	0023.584 0077.375	L&N IN WALK @ NELY COR OF BRIDGE OVER LA RIVER 7M NELY OF C/L ATLANTIC AVE	Y 11102
BASELINE (1995)	0027.733 0090.987	L&BR IN S CB 15.2M S/O C/L ARTESIA BL ON BRIDGE OVER ALAMEDA ST 5.5M W/O C/L PROD ON/OFF RAMP TO ALAMEDA ST	Y 11103
BELLFLOWER (1995)	0018.014 0059.101	DPW BM TAG IN S CB 67M E BCR 13.7M S & 99M E/O C/L INT ARTESIA BL & SANTA FE AVE UNDER BRIDGE FRWY OFF-RAMP	Y 11104
BELLFLOWER (1995)	0017.778 0058.327	DPW BM TAG IN E CB 1M N/O BCR @ NE COR ARTESIA BLVD & LONG BEACH BLVD 17M N & 11M E/O C/L INT	Y 11105
BELLFLOWER (1995)	0023.851 0078.251	DPW BM TAG IN S CB W ABUT OF BRIDGE OVER LA RIVER 12M S/O C/L ARTESIA BLVD & 10M E/O C/L DRWY RAMP TO LEVEE RD	Y 11106
BELLFLOWER (1995)	0017.471 0057.319	L&BR IN S CB 720MM E/O BCR @ SE COR MYRTLE AVE & ARTESIA BLVD 14M S & 12.5M E/O C/L INT	Y 11107
BELLFLOWER (1995)	0017.357 0056.945	RAMSET IN N END C B 2M N/O BCR @ NE COR WALNUT AVE & ARTESIA BLVD 23M N & 5.5M E/O C/L INT	Y 11108
BELLFLOWER (1995)	0018.934 0062.119	L&RCE TAG IN S CB 10.4M E/O E RAIL UPRR TRACKS & 13.7M S/O C/L ARTESIA BLVD (@ CONC ELEC BOX)	Y 11109

JAD-YEAR	ELEV METER/FOOT	DESCRIPTION (INCLUDE QUAD AND YEAR IN DESCRIPTION)	BM NUMBER
BELLFLOWER (1995)	0020.051 0065.784	L&BR IN W CB 300MM N/O BCR @ NW COR BELLFLOWER BLVD & RAMONA ST 13M W & 12.8M N/O C/L INT	Y 11110
BELLFLOWER (1995)	0020.499 0067.254	RAMSET IN S CB 300MM W/O BCR @ SW COR ARTESIA BL & BELLFLOWER BL 21M W & 12.5M S/O C/L INT	Y 11111
BELLFLOWER (1995)	0020.510 0067.290	DPW BM TAG IN E CB 1.7M N BCR @ NE COR ARTESIA BL & BELLFLOWER BL 22M N & 9M E/O C/L INT @ C B	Y 11112
BELLFLOWER (1995)	0021.168 0069.449	DPW BM TAG IN E CB 1M N/O BCR @ NE COR PARK ST & BELLFLOWER BL 11.6M N & 9M E/O C/L INT	Y 11113
BELLFLOWER (1995)	0022.058 0072.369	DPW BM TAG IN E CB 1M N/O BCR @ NE COR FLOWER ST & BELLFLOWER BL 17.4M N & 9M E/O C/L INT	Y 11114
BELLFLOWER (1995)	0022.044 0072.323	DPW BM TAG IN W CB 1M N/O BCR @ NW COR FLOWER ST & BELLFLOWER BL 14.3M N & 9M W/O C/L INT	Y 11115
BELLFLOWER (1995)	0022.696 0074.462	DPW BM TAG IN W CB 1.7M S/O BCR @ SW COR MAYNE ST & BELLFLOWER BL 11M S & 8.5M W/O C/L INT	Y 11116
BELLFLOWER (1995)	0008.184 0026.850	L&N IN S END C B 2M N/O BCR @ NW COR MEZZANINE WAY & CHARLEMAGNE AVE 19M N & 5.5M W/O C/L INT	Y 11117
BELLFLOWER (1995)	0009.529 0031.263	FC BR DISC IN S CB W SIDE FC CHANNEL 48M E & 12M S/O C/L INT WARDLOW RD & CHARLEMAGNE AVE MKD (BM 120-92 1961)	Y 11118
BELLFLOWER (1995)	0009.887 0032.438	FC BR DISC IN N CB E SIDE CHANNEL 61M E & 8.5M N/O C/L INT MONLACO RD & CHARLEMAGNE AVE MKD (BM 120-89 1961)	Y 11119
BELLFLOWER (1995)	0011.422 0037.474	FC BR DISC IN S HDWL E SIDE OF CHANNEL 60M E & 12M S/O C/L INT CONANT ST & CHARLEMAGNE AVE MKD (BM 120-92 1961)	Y 11120
LAKESWOOD (1995)	0017.279 0056.690	DPW BM TAG IN N CB 1M W/O BCR @ NW COR SOUTH ST & BELLFLOWER BLVD 26M W & 14.3M N/O C/L INT	Y 11121
LAKESWOOD (1995)	0017.142 0056.240	L&T IN N CB SOUTH ST 11.6M N/O C/L ON C/L PROD PEARCE AVE	Y 11122
LAKESWOOD (1995)	0017.090 0056.069	DPW BM TAG IN E CB 1M N/O BCR @ NE COR SOUTH ST & CLARK AVE 27.4M N & 9M E/O C/L INT	Y 11123
LAKESWOOD (1995)	0017.209 0056.460	NAIL&W IN E CB 59M N/O BCR @ NE COR SOUTH ST & FACULTY AVE 4.6M E & 71M N/O C/L INT (SERV RD)	Y 11124
LAKESWOOD (1995)	0015.330 0050.295	DPW BM TAG IN N CB 3M E/O BCR @ NE COR DEL AMO BLVD & LAKESWOOD BLVD 26M E & 12.2M N/O C/L INT	Y 11125

JAD-YEAR	ELEV METER/FOOT	D E S C R I P T I O N (INCLUDE QUAD AND YEAR IN DESCRIPTION)	BM NUMBER
LAKEWOOD (1995)	0015.307 0050.220	DPW BM TAG IN S CB 1M E/O BCR @ SE COR DEL AMO BLVD & LAKEWOOD BLVD 25M E & 12.2M S/O C/L INT	Y 11126
LAKEWOOD (1995)	0014.846 0048.707	DPW BM TAG IN N CB 1M E/O BCR @ NE COR DEL AMO BLVD (SERV RD) & PEARCE AVE 14.6M E & 4.3M N/O C/L INT (NR W END C B)	Y 11127
LAKEWOOD (1995)	0015.718 0051.568	DPW BM TAG IN E CB 1M N/O BCR @ NE COR DEL AMO BL & BELLFLOWER BL 24M N & 12.2M E/O C/L INT	Y 11128
LAKEWOOD (1995)	0014.824 0048.635	DPW BM TAG IN W CB 1M S/O BCR @ SW COR DEL AMO BL & WOODRUFF AVE 23.5M S & 12.2M W/O C/L INT	Y 11129